



Chicago Metropolitan Agency for Planning

233 South Wacker Drive
Suite 800
Chicago, Illinois 60606

312 454 0400
www.cmap.illinois.gov

CMAQ Project Selection Committee

Annotated Agenda

Thursday, April 11, 2013

2:00 p.m.

Teleconference # 800-747-5150, Access Code 3868824

Cook County Conference Room
233 S. Wacker Drive, Suite 800
Chicago, Illinois

- 1.0 Call to Order** 2:00 p.m.
- 2.0 Agenda Changes and Announcements**
- 3.0 Approval of Minutes—February 14, 2013**
ACTION REQUESTED: Approval
- 4.0 Program Monitoring**
- 4.1 Programming Project Status Sheets**
The recurring update report on the programming status of active projects and the line item changes since the last meeting of the Project Selection Committee is attached.
ACTION REQUESTED: Information
- 4.2 Obligation Report**
A draft of the report to be given to Council of Mayors Executive Committee will be available for the Committee's information.
ACTION REQUESTED: Information
- 4.3 Obligation Goal**
Staff will update the Committee on the overall obligations for this fiscal year.
ACTION REQUESTED: Discussion
- 4.4 Quarterly Transit Expenditure Update**
Staff has completed the analysis of 4th Quarter 2012 transit expenditures. An update will be given.
ACTION REQUESTED: Information

5.0 Project Changes

5.1 Melrose Park – North Ave Commuter Bicycle Path from Mannheim Rd to Thatcher Ave (TIP ID 04-08-0001)

The sponsor is requesting a scope change. Staff recommends approval.

5.2 Lake Zurich – US 12/Rand Road at Ela Road (TIP ID 10-02-0007)

The sponsor is requesting a cost increase. Staff recommends approval.

5.3 Sleepy Hollow – Bike Path along Sleepy Hollow Road from Thorobred Lane to Dundee Township Bird Sanctuary Trail Head (TIP ID 09-10-0002)

The sponsor is requesting to have the funding for construction restored from the deferral list in the amount of \$72,000 federal and a cost increase in the amount of \$33,600 federal. The sponsor demonstrated project phase readiness by submitting pre-final plans to IDOT. Staff undertook the restoration of deferred funding as an administrative change and recommends approval of the cost increase.

5.4 IEPA – Norfolk Southern Railway Co Switchyard Diesel Locomotive Retrofit Project (TIP ID 13-10-0005)

The sponsor is requesting a scope change and cost increase. Staff recommends consideration.

5.5 Rolling Meadows – Arlington Park Train Station Bicycle Lane Extension (TIP ID 03-08-0004)

The sponsor is requesting a cost increase. Staff recommends approval.

6.0 FY 2014-2018 Program Development

6.1 Status Update

Staff has begun to review and analyze the submitted project proposals. An update on the progress will be provided.

ACTION REQUESTED: Information

6.2 Focus Groups

Staff will provide an update on the status of the work of the focus groups.

ACTION REQUESTED: Information

7.0 MAP-21

An update will be provided on any newly available information related to MAP-21 and changes to the CMAQ program.

ACTION REQUESTED: Information

8.0 Other Business

9.0 Public Comment

This is an opportunity for comments from members of the audience. The amount of time available to speak will be at the chair's discretion. It should be noted that the exact time for the public comment period will immediately follow the last item on the agenda.

10.0 Next Meeting

The committee's next meeting is scheduled for May 23, 2013.

11.0 Adjournment

CMAQ Project Selection Committee Members:

____ Ross Patronsky, Chair

____ Bruce Carmitchel

____ Luann Hamilton

____ Mark Pitstick

____ Mike Rogers

____ Jeffery Schielke

____ Chris Snyder



DRAFT MINUTES

CMAQ Project Selection Committee

February 14, 2013 2:00 p.m.

CMAP Offices

- Committee Members Present:** Ross Patronsky, Chair (CMAP), Chris Snyder (counties), Bruce Carmitchel (IDOT), Mayor Keller (Council of Mayors), Mark Pitstick (RTA), Keith Privett (CDOT), Mike Rogers (IEPA)
- Staff Present:** Patricia Berry, Kama Dobbs, Doug Ferguson, Don Kopec, John O'Neal, Jose Rodriguez, Joy Schaad
- Others Present:** Mike Albin, Jennifer Becker, Stephen Berez, Kevin Bollinger, Bruce Christenson, Darwin Burkhart, Caitlyn Costello, Erin Cook, Chalen Daigle (via phone), Chris Demeroukas, John Donovan, Todd Gordon, Terry Heffron, Aimee Lee, Tom Lippert, Alexander McNally, Tom Rickert, Chad Riddle, Fred Shattner, Herbert Smith, Chris Staron, Brian Stepp, Mike Sullivan, David Tomzik, Paula Trigg, Mike Walczak
- 1.0 Call to Order**
Committee Chairman Ross Patronsky called the meeting to order at 2:05 p.m.
- 2.0 Agenda Changes and Announcements**
There were no changes or announcements.
- 3.0 Approval of Minutes—December 6, 2012**
On a motion by Mr. Carmitchel and a second by Mr. Snyder, the minutes of the December 6, 2012 meeting were approved as presented.
- 4.0 Program Monitoring**
- 4.1 Programming Project Status Sheets**
Mr. Ferguson drew the Committee's attention to two reports that were in the agenda posting. He reported on the list of deferred projects and on the status of active projects/line item changes since the last meeting of the Project Selection Committee.
- 4.2 Obligation Goal**
Mr. Ferguson noted that the obligation goal for the current year is \$123 million and the plan is to review whether or not there is a reasonable expectation that the

obligation goal can be met with the currently programmed projects or if vetted or extraordinary projects will be necessary to ensure that the goal is met. He said the \$33 million has been obligated so far in FFY 2013 between projects processed through FHWA and the transit projects processed through FTA. He also noted that \$21.3 million previously obligated has been moved to "Advance Construction" status which is typically done due to inactivity on the projects (i.e. no billing). There was discussion on IDOT's use of the advance construction provisions. Although projects in advance construction can move forward (without an obligation), the lack of obligation increases the risk that funds could be lost to rescission. Mr. Snyder requested that the columns in the obligation table be explained more fully, along with their relationship to each other.

Mr. Carmitchel reported that the amount of State appropriation planned for CMAQ could affect how much CMAQ funding can be obligated in FY 2013. He reported that currently there is \$50 million in State appropriation for CMAQ in SFY 13; however IDOT's Bureau of Local Roads has identified an additional \$25 million of reappropriation, for a total of \$75 million available to CMAQ in SFY 13. Considering that State appropriation also covers the local match, \$60 million in federal CMAQ funds can be obligated. He pointed out that transit obligations do not require State appropriation, so the \$12 million in planned transit obligations can move forward as well. He further stated that if the region is on track to meet the \$123 million obligation goal, IDOT's Bureau of Local Roads thinks that they can make further accommodation through additional reappropriation.

He commented that IDOT cannot assure there will be enough State appropriation for State fiscal years 2014-16. IDOT will need to ask for new appropriation if the region is successful at meeting its obligation goals. That appropriation will come out of appropriation planned for State projects. The discussion of the amount of appropriation needed for SFY 15 should take place around September 2013. IDOT is requesting that CMAP justify the level of State appropriation desired with information on specific projects that will be ready to go.

Chairman Patrosky asked Mr. Donovan for an update on the IDOT Process Review. He responded that there have been two meetings held so far as well as interviews with staff at the District offices. Mr. Donovan also reported that the interpretation of Buy America provisions is holding up some projects. IEPA's Clean Engine project was able to move forward, but the Cook County retrofit is still being held up; it appears that Cook County may be able to obtain domestically-produced engine filters. Buy America waivers are being handled on a case by case basis; a blanket waiver for retrofits and repowers is unlikely to be issued. He also noted that the Buy American provisions may make it difficult to comply with the requirement to spend 25% of the CMAQ funds on projects that help with particulate matter as required by MAP-21..

5.0 Project Changes

5.1 Lindenhurst Park District – Grass Lake Rd (TIP ID 10-09-0049)

The sponsor requested that funds for construction be moved into FFY 2013 from the multi-year B list and that the project receive a cost increase of \$1,738,000 total

(\$1,514,400 federal). The increase being sought is due to a revised engineer's estimate for construction. The project is on target for the April 26th, 2013 letting. On a motion by Mr. Snyder and a second by Mr. Rogers, the requests were approved.

5.2 Rolling Meadows - Arlington Park Train Station Bicycle Lane Extension (TIP ID 03-08-0004)

The sponsor requested a cost increase of \$147,534 total (\$63,771 federal) for a project cost of \$2,181,786 total (\$802,771 federal/CMAQ). On a motion by Mr. Snyder and a second by Mayor Keller, the request was approved.

5.3 Skokie – Skokie Valley Trail from Oakton to Village Limits (TIP ID 02-12-0002)

The sponsor requested a cost increase in the amount of \$314,537 total (\$251,630 federal) for construction. On a motion by Mr. Privett and a second by Mr. Snyder, the request was approved.

5.4 Lake County DOT – Roberts at River Rd (TIP ID 10-00-0128)

The sponsor requested a cost increase in the amount of \$2,923,750 total (\$2,339,000 federal). The sponsor has cited geotechnical issues encountered as part of phase I engineering and the remediation that will be required to construct the project among the reasons for the increased construction cost. On a motion by Mr. Snyder and a second by Mayor Keller, the cost increase was approved.

5.5 Elmhurst – IL56/Butterfield at Commonwealth Ln (TIP ID 08-09-0011)

The sponsor requested to transfer funds from right of way acquisition to construction, along with a cost increase of \$58,289 in CMAQ funds. This project is also using STP-L funds for construction. On a motion by Mr. Rogers and a second by Mr. Snyder, the requests were approved.

5.6 Aurora – Eola Rd from E New York St to Wolf's Crossing Rd (TIP ID 09-12-0004); Hill Ave. from Ohio St to Montgomery Ave (09-12-0002); and McCoy Dr./Commons Dr. from Gregory St./New York St. to IL 59/US 34 (TIP ID 09-12-0012)

The sponsor requested to move the construction phase for Eola Rd from East New York St to Wolf's Crossing Rd from FFY 2014 to FFY 2013, along with a cost increase of \$81,105 total (\$64,884 federal). On a motion by Mayor Keller and a second by Mr. Snyder, the Eola Road request was approved.

Aurora also requested to have the Hill Ave. from Ohio St to Montgomery Ave and McCoy Dr./Commons Dr. from Gregory St./New York St. to IL 59/US 34 construction phases moved from FFY 2014 to FFY 2013. On a motion by Mr. Privett and a second by Mr. Carmitchel, the requests were approved.

5.7 Lincolnwood – Touhy Ave Overpass (Skokie Valley Bike Trail) (TIP ID 02-12-0003)

The sponsor requested a cost increase in the amount of \$66,900 total (\$53,520 federal). On a motion by Mr. Privett and a second by Mr. Pitstick, the request was approved.

5.8 IEPA – Norfolk Southern Railway Co Switchyard Diesel Locomotive Retrofit Project (TIP ID 13-10-0005)

The sponsor requested a scope change to reduce the number of locomotives to be repowered from 4 to 3 and change the type of engine from Tier II switcher locomotive to a Tier III line-haul locomotive. On a motion by Mr. Carmitchel and a second by Mr. Privett, the request was approved.

5.9 Lake Zurich – Lake Zurich-US 12/Rand Road at Ela Road (TIP ID 10-02-0007)

The sponsor requested to have phase II engineering reinstated from the deferred projects list in the federal amount of \$35,000. The sponsor has indicated that phase I engineering has been accomplished. The status was confirmed by IDOT. Staff undertook this as an administrative change.

6.0 FY 2014-2018 Program Development

6.1 Call for Projects

Mr. Ferguson called attention to the summary of FFY 2014-18 project applications. He said that 145 applications for just over \$1 billion in CMAQ funding were received. That number is down from 310 applications in the last round. Bicycle and pedestrian facility applications are down from 95 to 49. Mr. Ferguson suggested that applicants are refraining from submitting projects that are not regionally significant; hence we received fewer, more regional applications. Mr. Ferguson noted that staff would be reviewing all proposals to assure that requirements for engineering have been or will be met as specified by the policies. Mr. Snyder asked how much funding would be available for programming. Mr. Ferguson responded that the plan is to develop the programming marks at the July meeting with the data available at that time.

6.2 Focus Groups

Chairman Patronsky reported that none of the focus groups had met since the last update. He also reported that during the Focus Group meetings last fall, the Bicycle and Pedestrian Task Force looked for significant projects in the region that were having a hard time moving forward. They identified one such project, which had a willing sponsor and had previously been submitted for CMAQ funding, but for which the funding ineligibility of phase I engineering was an issue. The Task Force has recommended this project for phase I funding under the “direct identification” language in the programming and program management policies. Staff is recommending that this project be allowed to move forward through the review process for consideration. However, the intent of direct identification was to find significant projects that so far had not been sponsored and solicit sponsorship, using phase I funding as an incentive. He said that the language in the policies will be improved to clarify this point during the next update.

7.0 MAP-21

There was no new information to present. As discussed earlier in the meeting, Buy America remains a substantial hurdle to implementing the required PM reduction projects.

8.0 Other Business

There was no other business.

9.0 Public Comment

There was no public comment.

10.0 Next Meeting

The committee's next meeting was scheduled for April 11, 2013.

11.0 Adjournment

The meeting adjourned at 3:03



| TIP ID | Sponsor | Brief Description | Phase | CMAQ \$ (Fed) | Increases* | Withdrawals* | Obligations* | Balance |
|-------------|---------|---|--------------|--------------------|-------------|--------------|---------------|--------------------|
| 2013 | | | | | | | | |
| 09-12-0002 | Aurora | Hill Av from Ohio St to Montgomery Rd | CONST | \$546,600 | | | | \$546,600 |
| 09-12-0004 | Aurora | Eola Rd from E New York St to Wolf's Crossing Rd | CONST | \$1,378,200 | \$64,884 C | | | \$1,443,084 |
| 09-12-0012 | Aurora | McCoy Dr/Commons Dr from Gregory St/New York St to IL 59/US34 | CONST | \$687,100 | \$171,775 C | | | \$858,875 |
| 09-12-0005 | Batavia | Pedestrian Crossings Various (8) Locations along IL 31 and IL 25 | ENG1 | \$33,600 | \$0 C | \$33,600 T | | \$0 |
| 01-01-0009 | CDOT | CDOT-Lakefront Trail-Navy Pier Flyover | CONST | \$4,128,000 | \$0 | | \$4,057,600 O | \$70,400 |
| | | | <i>CONST</i> | <i>\$4,128,000</i> | | | | <i>\$4,128,000</i> |
| 01-01-0009 | CDOT | CDOT-Lakefront Trail-Navy Pier Flyover | CONST | \$7,200,000 | | | | \$7,200,000 |
| 01-02-0027 | CDOT | Cicero Ave Smart Corridor | CONST | \$1,387,000 | \$800,000 C | | | \$2,187,000 |
| 01-03-0002 | CDOT | Stony Island Ave from Midway Plaisance to US 12/US 20/95th St | CONST | \$4,352,000 | | \$320,000 T | | \$4,032,000 |
| 01-03-0004 | CDOT | Roosevelt Rd from Western Ave to US 41/Lake Shore Dr | ENG | \$638,400 | | \$538,400 O | | \$100,000 |
| 01-05-0002 | CDOT | 41st St Bicycle-Pedestrian Bridge | ENG2 | \$880,000 | | | | \$880,000 |
| 01-06-0002 | CDOT | 43rd St Bicycle-Pedestrian Bridge | ENG2 | \$868,578 | | | | \$868,578 |
| 01-06-0004 | CDOT | Walk Chicago-Pedestrian Encouragement Program | IMP | \$160,000 | | | | \$160,000 |
| 01-06-0005 | CDOT | Walk to Transit - Pedestrian Improvements to Intersections near CTA Rail Stations | ENG1 | \$188,000 | | | | \$188,000 |

*Increase, Withdrawal and Obligation codes can be found at the end of this report.

Lines highlighted and shown in italics represent line item status as of prior PSC meeting.

| TIP ID | Sponsor | Brief Description | Phase | CMAQ \$ (Fed) | Increases* | Withdrawals* | Obligations* | Balance |
|------------|---------|--|-------|---------------|---------------|---------------|----------------|--------------|
| 01-08-0002 | CDOT | Bloomington Trail | ENG2 | \$2,240,000 | \$0 T | \$2,240,000 T | | \$0 |
| 01-08-0002 | CDOT | Bloomington Trail | ENG2 | \$480,000 | | | | \$480,000 |
| 01-08-0002 | CDOT | Bloomington Trail | CONST | \$34,300,000 | \$4,440,000 T | | | \$38,740,000 |
| 01-08-0004 | CDOT | City of Chicago Bicycle Fleet Program | IMP | \$80,000 | | | | \$80,000 |
| 01-09-0004 | CDOT | Union Station Transportation Center | ROW | \$4,720,000 | \$1,600,000 C | | \$4,720,000 O | \$1,600,000 |
| 01-12-0002 | CDOT | Arterial VMS Traveler Information System, Phase I | ENG | \$172,000 | | | | \$172,000 |
| 01-12-0004 | CDOT | Chicago Area Alternative Fuel Deployment Project, Phase 2 | IMP | \$15,000,000 | | | \$15,000,000 O | \$0 |
| 01-12-0005 | CDOT | Arterial Detection System Improvements | IMP | \$140,800 | | | | \$140,800 |
| 01-12-0005 | CDOT | Arterial Detection System Improvements | IMP | \$412,000 | | | | \$412,000 |
| 01-12-0006 | CDOT | US 41/Lakeshore Dr and Columbus Dr from Monroe Dr to US 41/Waldron Dr (1600 S) | ENG | \$124,000 | | | | \$124,000 |
| 01-12-0006 | CDOT | US 41/Lakeshore Dr and Columbus Dr from Monroe Dr to US 41/Waldron Dr (1600 S) | IMP | \$820,000 | | | | \$820,000 |
| 01-12-0007 | CDOT | IL 19/Irving Park Rd from Western Av to US 41/Lake Shore Dr | ENG | \$122,000 | | | | \$122,000 |
| 01-12-0007 | CDOT | IL 19/Irving Park Rd from Western Av to US 41/Lake Shore Dr | IMP | \$806,000 | | | | \$806,000 |
| 01-94-0045 | CDOT | Bike Parking | ENG | \$480,000 | \$257,523 T | | | \$737,523 |
| 01-94-0045 | CDOT | Bike Parking | IMP | \$1,520,000 | \$441,890 T | | | \$1,961,890 |
| 01-94-0092 | CDOT | BIKE FAC-CHICAGO-STREETS FOR CYCLING/BIKE 2015 Plan Implementation | IMP | \$23,360,000 | \$77,315 T | | | \$23,437,315 |
| 01-97-0093 | CDOT | 95th St from Western Ave to US 41/Ewing Ave | CONST | \$3,460,000 | | | | \$3,460,000 |
| 01-97-0093 | CDOT | 95th St from Western Ave to US 41/Ewing Ave | CONST | \$4,360,000 | | | | \$4,360,000 |

*Increase, Withdrawal and Obligation codes can be found at the end of this report.

Lines highlighted and shown in italics represent line item status as of prior PSC meeting.

3/26/2013 3:04:14 PM

| TIP ID | Sponsor | Brief Description | Phase | CMAQ \$ (Fed) | Increases* | Withdrawals* | Obligations* | Balance | |
|------------|-------------------|---|-------|---------------|------------|--------------|--------------|-------------|-------------|
| 01-98-0080 | CDOT | CDOT Peterson Ave from Cicero to Ridge Signal Interconnect | CONST | \$1,912,382 | \$388,800 | T | | \$2,301,182 | |
| 11-12-0004 | Crystal Lake | Crystal Lake Bikeway Corridor Improvements | CONST | \$60,468 | \$52,740 | C | | \$113,208 | |
| 01-10-0004 | CTA | Diesel Particulate Filter Retrofit for CTA Buses 404.024 | IMP | \$11,920,000 | | | \$11,920,000 | O \$0 | |
| 03-08-0002 | Des Plaines | Central Ave from Wolf Rd to East River Rd | ENG1 | \$27,000 | | | | \$27,000 | |
| 03-12-0011 | Des Plaines | Des Plaines - Pedestrian Refuge Medians | CONST | \$144,800 | | \$73,414 | S | \$71,386 | |
| 08-09-0016 | DuPage County DOT | 75th St at Cass Ave and Plainfield Rd | ROW | \$100,000 | \$25,000 | C | | \$125,000 | |
| 08-09-0016 | DuPage County DOT | 75th St at Cass Ave and Plainfield Rd | ENG2 | \$440,000 | \$37,800 | C | \$477,800 | O \$0 | |
| 08-09-0016 | DuPage County DOT | 75th St at Cass Ave and Plainfield Rd | CONST | \$9,560,000 | | | | \$9,560,000 | |
| 08-12-0004 | DuPage County DOT | 55th St/CH 35 from Dunham Rd to Clarendon Hills Rd and 55th St at Main St | ENG1 | \$52,000 | | \$52,000 | S | \$0 | |
| 08-12-0006 | DuPage County DOT | Fabyan Pkwy/Washington St at Roosevelt Rd | ROW | \$200,000 | \$50,000 | C | | \$250,000 | |
| 08-12-0006 | DuPage County DOT | Fabyan Pkwy/Washington St at Roosevelt Rd | ENG2 | \$525,000 | \$225,000 | C | | \$750,000 | |
| 08-12-0011 | DuPage County DOT | DuPage Co Central Signal System - Phase I | ENG2 | \$80,000 | | | | \$80,000 | |
| 08-12-0011 | DuPage County DOT | DuPage Co Central Signal System - Phase I | CONST | \$636,000 | | | | \$636,000 | |
| 08-12-0012 | DuPage County DOT | DuPage Co Central Signal System - Phase II | ENG2 | \$80,000 | | | | \$80,000 | |
| 09-09-0007 | Elgin | Elgin Bikeway Plan Route 4 SW Quadrant | CONST | \$2,397,000 | | | | \$2,397,000 | |
| 09-12-0009 | Elgin | Elgin CBD Bike Racks Program | ENG2 | \$8,000 | | | | \$8,000 | |
| 09-12-0009 | Elgin | Elgin CBD Bike Racks Program | CONST | \$68,800 | | | | \$68,800 | |
| 03-10-0005 | Elk Grove Village | IL72/Higgins Road Overpass in Busse Woods | CONST | \$3,140,000 | | | | \$3,140,000 | |
| 08-09-0011 | Elmhurst | IL 56/Butterfield Rd at Commonwealth Ln | CONST | \$377,180 | \$134,289 | T | \$76,000 | T \$301,180 | O \$134,289 |

*Increase, Withdrawal and Obligation codes can be found at the end of this report.

Lines highlighted and shown in italics represent line item status as of prior PSC meeting.

3/26/2013 3:04:16 PM

| TIP ID | Sponsor | Brief Description | Phase | CMAQ \$ (Fed) | Increases* | Withdrawals* | Obligations* | Balance |
|------------|--|---|-------|---------------|------------|--------------|--------------|-----------|
| 08-12-0003 | Elmhurst | IL 56/Butterfield Rd at York St | ENG1 | \$112,000 | | | | \$112,000 |
| 02-12-0006 | Evanston | Dempster St from Fowler Av to Ridge Av | ENG1 | \$24,000 | \$0 | | | \$24,000 |
| 12-12-0001 | Forest Preserve District of Will County | DuPage River Trail - Segment 5 | ENG1 | \$72,000 | | | \$71,833 O | \$167 |
| 12-12-0004 | Frankfort | St Francis Rd Multi-Use Trail | ENG1 | \$12,000 | | \$12,000 T | | \$0 |
| 12-12-0004 | Frankfort | St Francis Rd Multi-Use Trail | ENG2 | \$12,000 | | | | \$12,000 |
| 07-08-0002 | Hazel Crest | New Commuter Parking Lot on the NW corner of 171st St at Park Ave. | ROW | \$88,000 | | | | \$88,000 |
| 07-08-0002 | Hazel Crest | New Commuter Parking Lot on the NW corner of 171st St at Park Ave. | ENG2 | \$20,000 | | | | \$20,000 |
| 07-08-0002 | Hazel Crest | New Commuter Parking Lot on the NW corner of 171st St at Park Ave. | CONST | \$320,000 | | | | \$320,000 |
| 04-12-0002 | Hillside | Butterfield Rd from Wolf Rd to Mannheim Rd | ROW | \$640,000 | | | | \$640,000 |
| 04-12-0002 | Hillside | Butterfield Rd from Wolf Rd to Mannheim Rd | CONST | \$452,000 | | | | \$452,000 |
| 12-12-0002 | Homer Glen | Homer Glen Community Trail - South Extension | ENG1 | \$31,000 | | | \$30,192 O | \$808 |
| 12-12-0002 | Homer Glen | Homer Glen Community Trail - South Extension | ENG2 | \$31,000 | | | | \$31,000 |
| 03-12-0002 | IDOT | IL 59 at W Bartlett Rd | ROW | \$96,000 | | | | \$96,000 |
| 03-12-0002 | IDOT | IL 59 at W Bartlett Rd | CONST | \$480,000 | | | | \$480,000 |
| 07-12-0001 | IDOT | IL 394 at Sauk Trail | ROW | \$108,000 | | | \$108,000 O | \$0 |
| 07-12-0001 | IDOT | IL 394 at Sauk Trail | CONST | \$540,000 | | | | \$540,000 |
| 08-00-0008 | IDOT | IL 53 from North Ave/IL 64 to St Charles Rd | CONST | \$209,000 | | | | \$209,000 |
| 09-10-0016 | IDOT | IL 47 at Plato Rd | ROW | \$160,000 | | | | \$160,000 |

*Increase, Withdrawal and Obligation codes can be found at the end of this report.

Lines highlighted and shown in italics represent line item status as of prior PSC meeting.

3/26/2013 3:04:18 PM

| TIP ID | Sponsor | Brief Description | Phase | CMAQ \$ (Fed) | Increases* | Withdrawals* | Obligations* | Balance |
|--|-----------------|--|--------------|------------------|--------------------|----------------|---------------|--------------------|
| 09-12-0003 | IDOT | IL 47/72/Higgins Rd at US 20 | ROW | \$160,000 | | | \$160,000 O | \$0 |
| 09-12-0003 | IDOT | IL 47/72/Higgins Rd at US 20 | CONST | \$1,400,000 | \$1,240,000 C | | | \$2,640,000 |
| 09-12-0007 | IDOT | IL 47/72 at US 20 | ROW | \$160,000 | | | \$157,600 O | \$2,400 |
| 09-12-0007 | IDOT | IL 47/72 at US 20 | CONST | \$1,000,000 | \$600,000 C | | | \$1,600,000 |
| 12-12-0005 | IDOT | US 6/Southwest Hwy at Gougar Rd | ROW | \$160,000 | | | | \$160,000 |
| 12-12-0010 | IDOT | US 6/Southwest Hwy at Parker Rd | ROW | \$160,000 | | | | \$160,000 |
| 13-10-0005 | IEPA | Norfolk Southern Railway Co Switchyard Diesel Locomotive Retrofit Project | IMP | \$3,380,000 | \$0 | | | \$3,380,000 |
| 13-12-0003 | IEPA | Illinois Clean Diesel Engine Repowers | IMP | \$1,000,000 | \$4,000,000 I | | \$5,000,000 O | \$0 |
| 13-97-0002 | IEPA | Clean Air Public Information Campaign and Regional Carpool Radio Advertising | IMP | \$3,000,000 | | | | \$3,000,000 |
| 09-10-0003 | Kane County | Fabyan Pwy from Nagle Blv to IL 25 | CONST | \$1,628,700 | \$25,472 I | | | \$1,654,172 |
| 09-11-0013 | Kane County | Arterial Management Center | CONST | \$558,740 | \$296,200 C | | | \$854,940 |
| 09-06-0068 | Kane County DOT | Burlington Rd at IL 47 - Roundabout | CONST | \$856,000 | \$1,000,000 C | \$8,000 U | | \$1,848,000 |
| <i>Previously programmed in FFY 2014</i> | | | <i>CONST</i> | <i>\$856,000</i> | <i>\$1,000,000</i> | <i>\$8,000</i> | | <i>\$1,848,000</i> |
| 09-08-0002 | Kane County DOT | Kirk Rd at Douglas Rd | ROW | \$160,000 | \$0 | | \$160,000 O | \$0 |
| 09-09-0010 | Kane County DOT | Huntley Rd at Galligan Rd | ROW | \$248,000 | \$0 | | \$248,000 O | \$0 |
| | | | <i>ROW</i> | <i>\$248,000</i> | <i>\$0</i> | | | <i>\$248,000</i> |
| 09-12-0006 | Kane County DOT | Fabyan Pkwy/CH 8 at Kaneville Rd/CH 84 | ENG1 | \$88,000 | | | \$83,710 O | \$4,290 |
| 09-12-0010 | Kane County DOT | Kane County Bike Rack Program | IMP | \$67,200 | | | | \$67,200 |
| 09-12-0014 | Kane County DOT | Stearns Rd/CH 37 from Randall Rd to Kane/DuPage County Line | ENG2 | \$160,000 | | | \$130,267 O | \$29,733 |
| 10-00-0113 | Lake County DOT | Cedar Lake Rd at Monaville Rd | CONST | \$4,325,000 | | | \$1,748,682 O | \$2,576,318 |
| 10-00-0128 | Lake County DOT | Roberts Rd at River Rd | CONST | \$4,530,000 | \$2,339,000 C | \$39,461 T | | \$6,829,539 |

*Increase, Withdrawal and Obligation codes can be found at the end of this report.

Lines highlighted and shown in italics represent line item status as of prior PSC meeting.

3/26/2013 3:04:19 PM

| TIP ID | Sponsor | Brief Description | Phase | CMAQ \$ (Fed) | Increases* | Withdrawals* | Obligations* | Balance | |
|------------|--------------------------------------|---|--------------|------------------|-------------|------------------|--------------|------------------|-------------|
| 10-00-0129 | Lake County DOT | Hart Rd at US 14/W Northwest Hwy | ROW | \$659,000 | | | | \$659,000 | |
| 10-00-0129 | Lake County DOT | Hart Rd at US 14/W Northwest Hwy | ENG2 | \$506,000 | | | | \$506,000 | |
| 10-08-0031 | Lake County DOT | Washington St/CH A22 at CN/Metra Crossing | CONST | \$16,939,000 | | | | \$16,939,000 | |
| 10-10-0002 | Lake County DOT | Washington St Bike Path (sidepath) | ENG2 | \$40,000 | \$107,373 | T | | \$147,373 | |
| 10-10-0002 | Lake County DOT | Washington St Bike Path (sidepath) | CONST | \$624,480 | | \$166,601 | T | \$457,879 | |
| | | | <i>CONST</i> | <i>\$624,480</i> | | <i>\$107,373</i> | | <i>\$517,107</i> | |
| | | | <i>CONST</i> | <i>\$624,480</i> | | <i>\$59,228</i> | | <i>\$565,252</i> | |
| 10-12-0003 | Lake County DOT | Aptakasic Rd Adaptive Traffic Control | CONST | \$355,100 | \$35,510 | I | \$390,610 | O | \$0 |
| 10-12-0004 | Lake County DOT | Gilmer/Hawley/IL176 Adaptive Traffic Control | CONST | \$939,190 | \$93,920 | I | \$1,033,110 | O | \$0 |
| 10-12-0002 | Lake Forest | Bicycle Parking Facility adjacent to Lake Forest Train Station | ENG1 | \$2,080 | | | | | \$2,080 |
| 10-12-0002 | Lake Forest | Bicycle Parking Facility adjacent to Lake Forest Train Station | ENG2 | \$4,160 | | | | | \$4,160 |
| 02-10-0001 | Lincolnwood | Lincolnwood Union Pacific (UP) Rail Line/Weber Spur Bike/Multiuse Trail | ROW | \$4,800,000 | | | | | \$4,800,000 |
| 02-10-0001 | Lincolnwood | Lincolnwood Union Pacific (UP) Rail Line/Weber Spur Bike/Multiuse Trail | ENG2 | \$52,000 | | | | | \$52,000 |
| 02-10-0002 | Lincolnwood | Lincolnwood Commonwealth Edison (ComEd) Utility ROW / Skokie Valley Bike/Multiuse Trail | ENG2 | \$84,000 | | \$28,000 | T | | \$56,000 |
| 02-12-0003 | Lincolnwood | Touhy Av Overpass (Skokie Valley Bike Trail) | ENG1 | \$88,000 | \$53,520 | C | | | \$141,520 |
| 10-12-0021 | Lindenhurst Park District | Grass Lake Rd Underpass | CONST | \$993,000 | \$1,473,000 | C | | | \$2,466,000 |
| 11-03-0007 | McHenry | IL 31 from McCullom Lake Rd to IL 120 | CONST | \$554,959 | \$2,190,041 | C | | | \$2,745,000 |
| 11-06-0032 | McHenry | Miller Rd/Bull Valley Rd at N. Front St and Green St | CONST | \$1,556,440 | | | | | \$1,556,440 |
| 11-96-0007 | McHenry County Conservation District | BIKE FAC-MCHENRY CONSERVATION DISTRICT-WOODSTOCK CRYSTAL LAKE BIKEWAY | CONST | \$419,200 | | | | | \$419,200 |

*Increase, Withdrawal and Obligation codes can be found at the end of this report.

Lines highlighted and shown in italics represent line item status as of prior PSC meeting.

3/26/2013 3:04:21 PM

| TIP ID | Sponsor | Brief Description | Phase | CMAQ \$ (Fed) | Increases* | Withdrawals* | Obligations* | Balance | |
|-------------------|---|--|-------|---------------|-------------|--------------|--------------|---------|-------------|
| 11-04-0001 | McHenry County Division of Transportation | Johnsburg Rd IL 31 - Chapel Hill Rd | CONST | \$1,604,259 | \$3,032,988 | T | \$4,570,878 | O | \$66,369 |
| 03-12-0010 | Mount Prospect | Golf Rd Alt. 3 Regional Bike Route | ENG1 | \$8,000 | | | | | \$8,000 |
| 03-12-0012 | Niles | Cleveland St Crosswalks from Waukegan Rd to Caldwell Av | ENG1 | \$8,000 | | | | | \$8,000 |
| 04-12-0007 | Northlake | Northwest Av from Grand Av to North Av | ENG1 | \$57,200 | | | \$57,111 | O | \$89 |
| 04-12-0007 | Northlake | Northwest Av from Grand Av to North Av | ENG2 | \$57,200 | | | | | \$57,200 |
| 04-12-0007 | Northlake | Northwest Av from Grand Av to North Av | CONST | \$629,600 | | | | | \$629,600 |
| 04-12-0001 | Oak Park | Madison St from Home Av to Lombard Av | ENG1 | \$52,000 | | | | | \$52,000 |
| 04-12-0004 | Oak Park | Oak Park Traffic Signal Management System | CONST | \$100,960 | \$3,360 | T | \$104,320 | O | \$0 |
| 04-12-0005 | Oak Park | Bike Parking along North Blv from Marion St to Forest Av and at Parking Lots at the CTA Oak Park Blue Line Station | ENG2 | \$20,000 | | | | | \$20,000 |
| 04-12-0005 | Oak Park | Bike Parking along North Blv from Marion St to Forest Av and at Parking Lots at the CTA Oak Park Blue Line Station | ENG2 | \$20,000 | | | | | \$20,000 |
| 17-12-0001 | Pace | I-90 Corridor Enhanced Markets | ENG1 | \$1,000,000 | | | | | \$1,000,000 |
| 17-12-0001 | Pace | I-90 Corridor Enhanced Markets | ENG2 | \$2,000,000 | | | | | \$2,000,000 |
| 17-12-0003 | Pace | Transit Diesel Engine Retrofits 2012-2016 | IMP | \$3,060,000 | | | | | \$3,060,000 |
| 17-12-0004 | Pace | I-55 Corridor Market Enhancement | IMP | \$719,250 | | | | | \$719,250 |
| 07-08-0010 | Riverdale | CSXT Barr Rail Yard Switch Engine Retrofit | IMP | \$795,000 | \$780,000 | C | | | \$1,575,000 |
| 03-08-0004 | Rolling Meadows | Arlington Park Train Station Bicycle Lane Extension | CONST | \$420,000 | \$167,000 | C | | | \$587,000 |
| 08-05-0002 | RTA | DuPage County Transit Service Marketing | IMP | \$480,000 | | | | | \$480,000 |
| 02-12-0004 | Skokie | Old Orchard Rd from Skokie Blv to Gross Point Rd | ROW | \$33,000 | | | | | \$33,000 |

*Increase, Withdrawal and Obligation codes can be found at the end of this report.

Lines highlighted and shown in italics represent line item status as of prior PSC meeting.

3/26/2013 3:04:22 PM

| TIP ID | Sponsor | Brief Description | Phase | CMAQ \$ (Fed) | Increases* | Withdrawals* | Obligations* | Balance |
|--|--|---|-------|----------------------|---------------------|--------------------|---------------------|----------------------|
| 07-10-0001 | Tinley Park | 183rd St at Oak Park Ave | ROW | \$320,000 | | | | \$320,000 |
| 07-10-0001 | Tinley Park | 183rd St at Oak Park Ave | ENG2 | \$144,000 | | | | \$144,000 |
| 08-12-0008 | Wheaton | Sign the Wheaton Bicycle Network | ENG2 | \$14,400 | | | | \$14,400 |
| 08-12-0008 | Wheaton | Sign the Wheaton Bicycle Network | CONST | \$129,760 | | | | \$129,760 |
| 08-12-0009 | Wheaton | Various Downtown Bicycle Racks | IMP | \$36,000 | | | | \$36,000 |
| 12-08-0003 | Will County Department of Highways | Laraway Rd at Cedar Rd | ENG2 | \$200,000 | | \$200,000 | T | \$0 |
| 128 line items in 2013 totalling: | | | | \$213,746,786 | \$26,204,400 | \$3,787,476 | \$50,530,893 | \$185,632,817 |
| 2014 | | | | | | | | |
| 11-12-0006 | Algonquin | Randall Rd Pedestrian Crossing from Golden Eagle Dr to Stonegate Rd | ROW | \$320,000 | | | | \$320,000 |
| 11-12-0006 | Algonquin | Randall Rd Pedestrian Crossing from Golden Eagle Dr to Stonegate Rd | ENG2 | \$120,000 | | | | \$120,000 |
| 09-12-0005 | Batavia | Pedestrian Crossings Various (8) Locations along IL 31 and IL 25 | ENG2 | \$33,600 | \$33,600 | T | | \$67,200 |
| 07-12-0004 | Burnham | Burnham Greenway Trail from State St to Brainard and Burnham | CONST | \$3,161,600 | \$0 | | | \$3,161,600 |
| 01-06-0005 | CDOT | Walk to Transit - Pedestrian Improvements to Intersections near CTA Rail Stations | ENG2 | \$372,000 | | | | \$372,000 |
| 01-06-0005 | CDOT | Walk to Transit - Pedestrian Improvements to Intersections near CTA Rail Stations | CONST | \$688,000 | | \$160,000 | T | \$528,000 |
| 01-12-0002 | CDOT | Arterial VMS Traveler Information System, Phase I | IMP | \$1,141,200 | | | | \$1,141,200 |
| 01-12-0005 | CDOT | Arterial Detection System Improvements | IMP | \$140,800 | | | | \$140,800 |
| 01-97-0092 | CDOT | IL 50/Cicero Ave from US 14/Peterson Ave to Lexington Ave | CONST | \$8,108,000 | | | | \$8,108,000 |
| 10-06-0003 | Deerfield | Deerfield Rd Sidewalk | CONST | \$302,492 | \$84,172 | C | \$84,172 | T \$302,492 |

*Increase, Withdrawal and Obligation codes can be found at the end of this report.

Lines highlighted and shown in italics represent line item status as of prior PSC meeting.

3/26/2013 3:04:23 PM

| TIP ID | Sponsor | Brief Description | Phase | CMAQ \$ (Fed) | Increases* | Withdrawals* | Obligations* | Balance |
|-------------------|---|---|-------|---------------|------------|--------------|--------------|-------------|
| 03-12-0005 | Des Plaines | Ballard Rd from Bender Rd to Good Av | ROW | \$40,000 | | | | \$40,000 |
| 03-12-0005 | Des Plaines | Ballard Rd from Bender Rd to Good Av | ENG2 | \$20,000 | | | | \$20,000 |
| 08-12-0004 | DuPage County DOT | 55th St/CH 35 from Dunham Rd to Clarendon Hills Rd and 55th St at Main St | ROW | \$148,000 | | | | \$148,000 |
| 08-12-0004 | DuPage County DOT | 55th St/CH 35 from Dunham Rd to Clarendon Hills Rd and 55th St at Main St | ENG2 | \$80,000 | | | | \$80,000 |
| 08-12-0004 | DuPage County DOT | 55th St/CH 35 from Dunham Rd to Clarendon Hills Rd and 55th St at Main St | ENG2 | \$104,000 | | | | \$104,000 |
| 08-12-0005 | DuPage County DOT | Schmale Rd/CH 38 from Bloomingdale Ct to Fullerton Rd | CONST | \$352,000 | | | | \$352,000 |
| 08-12-0006 | DuPage County DOT | Fabyan Pkwy/Washington St at Roosevelt Rd | CONST | \$5,600,000 | | | | \$5,600,000 |
| 08-12-0012 | DuPage County DOT | DuPage Co Central Signal System - Phase II | CONST | \$596,800 | | | | \$596,800 |
| 08-12-0003 | Elmhurst | IL 56/Butterfield Rd at York St | ROW | \$349,920 | | | | \$349,920 |
| 08-12-0003 | Elmhurst | IL 56/Butterfield Rd at York St | ENG2 | \$128,000 | | | | \$128,000 |
| 02-12-0006 | Evanston | Dempster St from Fowler Av to Ridge Av | ENG2 | \$51,000 | | | | \$51,000 |
| 02-12-0006 | Evanston | Dempster St from Fowler Av to Ridge Av | CONST | \$717,000 | | | | \$717,000 |
| 12-12-0001 | Forest Preserve District of Will County | DuPage River Trail - Segment 5 | ENG2 | \$68,000 | | | | \$68,000 |
| 12-12-0001 | Forest Preserve District of Will County | DuPage River Trail - Segment 5 | CONST | \$1,232,000 | | | | \$1,232,000 |
| 12-12-0004 | Frankfort | St Francis Rd Multi-Use Trail | CONST | \$118,000 | \$12,000 | T | | \$130,000 |
| 12-12-0002 | Homer Glen | Homer Glen Community Trail - South Extension | CONST | \$31,000 | | | | \$31,000 |
| 12-12-0002 | Homer Glen | Homer Glen Community Trail - South Extension | CONST | \$360,000 | | | | \$360,000 |
| 03-12-0001 | IDOT | IL 68/E Dundee Rd at S Barrington Rd | ROW | \$96,000 | | | | \$96,000 |
| 03-12-0004 | IDOT | IL 59/Sutton Rd at Stearns Rd | ROW | \$160,000 | | | | \$160,000 |

*Increase, Withdrawal and Obligation codes can be found at the end of this report.

Lines highlighted and shown in italics represent line item status as of prior PSC meeting.

3/26/2013 3:04:25 PM

| TIP ID | Sponsor | Brief Description | Phase | CMAQ \$ (Fed) | Increases* | Withdrawals* | Obligations* | Balance |
|-------------------|-----------------|---|-------|---------------|------------|--------------|--------------|-------------|
| 03-12-0006 | IDOT | Barrington Rd at Bode Rd | ROW | \$64,000 | | | | \$64,000 |
| 03-12-0008 | IDOT | IL 68/Dundee Rd at Kennicott Av | ROW | \$56,000 | | | | \$56,000 |
| 03-12-0009 | IDOT | IL 19/Irving Park Rd at IL 59 | ROW | \$56,000 | | | | \$56,000 |
| 03-12-0014 | IDOT | IL 68/Dundee Rd at McHenry Rd/Wheeling Rd | ROW | \$160,000 | | | | \$160,000 |
| 03-12-0015 | IDOT | IL 68/Dundee Rd at IL 83 | ROW | \$160,000 | | | | \$160,000 |
| 08-12-0013 | IDOT | IL 59 at IL 38 (north ramps) | ROW | \$80,000 | | | | \$80,000 |
| 09-10-0016 | IDOT | IL 47 at Plato Rd | CONST | \$2,400,000 | | | | \$2,400,000 |
| 10-12-0005 | IDOT | IL 68/Dundee Rd at Buffalo Grove Rd | ROW | \$160,000 | | | | \$160,000 |
| 12-12-0005 | IDOT | US 6/Southwest Hwy at Gougar Rd | CONST | \$800,000 | | | | \$800,000 |
| 12-12-0006 | IDOT | US 30/Lincoln Hwy at I-55 Ramps | CONST | \$800,000 | | | | \$800,000 |
| 12-12-0010 | IDOT | US 6/Southwest Hwy at Parker Rd | CONST | \$2,400,000 | | | | \$2,400,000 |
| 09-08-0002 | Kane County DOT | Kirk Rd at Douglas Rd | CONST | \$720,000 | | | | \$720,000 |
| 09-09-0010 | Kane County DOT | Huntley Rd at Galligan Rd | CONST | \$1,058,840 | | | | \$1,058,840 |
| 09-12-0014 | Kane County DOT | Stearns Rd/CH 37 from Randall Rd to Kane/DuPage County Line | CONST | \$1,628,600 | | | | \$1,628,600 |
| 10-12-0001 | Lake County DOT | Lake St from Washington St to Belvidere Rd | ENG2 | \$49,100 | | | | \$49,100 |
| 10-12-0002 | Lake Forest | Bicycle Parking Facility adjacent to Lake Forest Train Station | CONST | \$41,600 | | | | \$41,600 |
| 02-10-0001 | Lincolnwood | Lincolnwood Union Pacific (UP) Rail Line/Weber Spur Bike/Multiuse Trail | CONST | \$688,000 | | | | \$688,000 |
| 02-10-0002 | Lincolnwood | Lincolnwood Commonwealth Edison (ComEd) Utility ROW / Skokie Valley Bike/Multiuse Trail | CONST | \$704,000 | | | | \$704,000 |
| 02-12-0003 | Lincolnwood | Touhy Av Overpass (Skokie Valley Bike Trail) | ENG2 | \$88,000 | | | | \$88,000 |

*Increase, Withdrawal and Obligation codes can be found at the end of this report.

Lines highlighted and shown in italics represent line item status as of prior PSC meeting.

3/26/2013 3:04:27 PM

| TIP ID | Sponsor | Brief Description | Phase | CMAQ \$ (Fed) | Increases* | Withdrawals* | Obligations* | Balance |
|---|------------------------------------|--|-------|---------------------|--------------------|------------------|--------------|---------------------|
| 03-12-0010 | Mount Prospect | Golf Rd Alt. 3 Regional Bike Route | ENG2 | \$12,000 | | | | \$12,000 |
| 03-12-0012 | Niles | Cleveland St Crosswalks from Waukegan Rd to Caldwell Av | CONST | \$94,000 | | | | \$94,000 |
| 04-12-0001 | Oak Park | Madison St from Home Av to Lombard Av | ENG2 | \$32,000 | | | | \$32,000 |
| 04-12-0005 | Oak Park | Bike Parking along North Blv from Marion St to Forest Av and at Parking Lots at the CTA Oak Park Blue Line Station | CONST | \$60,000 | | | | \$60,000 |
| 04-12-0005 | Oak Park | Bike Parking along North Blv from Marion St to Forest Av and at Parking Lots at the CTA Oak Park Blue Line Station | CONST | \$168,000 | | | | \$168,000 |
| 09-12-0008 | Oswego | Mill Rd Multi-use Path | CONST | \$190,400 | \$73,479 | C | | \$263,879 |
| 17-12-0001 | Pace | I-90 Corridor Enhanced Markets | CONST | \$12,500,000 | | | | \$12,500,000 |
| 17-12-0001 | Pace | I-90 Corridor Enhanced Markets | IMP | \$12,500,000 | | | | \$12,500,000 |
| 17-12-0003 | Pace | Transit Diesel Engine Retrofits 2012-2016 | IMP | \$2,280,000 | | | | \$2,280,000 |
| 17-12-0004 | Pace | I-55 Corridor Market Enhancement | IMP | \$719,250 | | | | \$719,250 |
| 02-12-0002 | Skokie | Skokie Valley Trail from Oakton St to Village Limits | CONST | \$544,000 | \$251,630 | C | | \$795,630 |
| 02-12-0004 | Skokie | Old Orchard Rd from Skokie Blv to Gross Point Rd | CONST | \$428,000 | | | | \$428,000 |
| 07-10-0001 | Tinley Park | 183rd St at Oak Park Ave | CONST | \$1,600,000 | | | | \$1,600,000 |
| 10-06-0065 | Waukegan | Waukegan/North Chicago Lake Front Bike Path | CONST | \$800,000 | \$117,600 | C | | \$917,600 |
| 12-08-0003 | Will County Department of Highways | Laraway Rd at Cedar Rd | CONST | \$2,433,600 | \$720,000 | T | | \$3,153,600 |
| 63 line items in 2014 totalling: | | | | \$71,114,802 | \$1,292,481 | \$244,172 | | \$72,163,111 |
| 2015 | | | | | | | | |
| 11-12-0006 | Algonquin | Randall Rd Pedestrian Crossing from Golden Eagle Dr to Stonegate Rd | CONST | \$2,600,000 | | | | \$2,600,000 |

*Increase, Withdrawal and Obligation codes can be found at the end of this report.

Lines highlighted and shown in italics represent line item status as of prior PSC meeting.

3/26/2013 3:04:28 PM

| TIP ID | Sponsor | Brief Description | Phase | CMAQ \$ (Fed) | Increases* | Withdrawals* | Obligations* | Balance |
|------------|--------------------------------|--|-------|---------------|------------|--------------|--------------|-------------|
| 09-12-0005 | Batavia | Pedestrian Crossings Various (8) Locations along IL 31 and IL 25 | CONST | \$419,200 | | | | \$419,200 |
| 01-05-0002 | CDOT | 41st St Bicycle-Pedestrian Bridge | CONST | \$187,771 | | | | \$187,771 |
| 01-06-0005 | CDOT | Walk to Transit - Pedestrian Improvements to Intersections near CTA Rail Stations | CONST | \$2,460,000 | | | | \$2,460,000 |
| 01-12-0005 | CDOT | Arterial Detection System Improvements | IMP | \$140,800 | | | | \$140,800 |
| 02-97-0006 | Cook County Highway Department | Old Orchard Rd from Harms to Skokie Blvd (new limits E of I-94/Edens Expy to W of IL 41/Skokie Blvd) | CONST | \$800,000 | \$0 | | | \$800,000 |
| 03-11-0020 | Cook County Highway Department | Lake Cook Rd at 3 IBuffalo Grove Rd, Weiland Rd and IL 83/McHenry Rd. | CONST | \$4,185,000 | | | | \$4,185,000 |
| 03-12-0005 | Des Plaines | Ballard Rd from Bender Rd to Good Av | CONST | \$346,400 | | | | \$346,400 |
| 08-12-0004 | DuPage County DOT | 55th St/CH 35 from Dunham Rd to Clarendon Hills Rd and 55th St at Main St | CONST | \$664,000 | | | | \$664,000 |
| 08-12-0004 | DuPage County DOT | 55th St/CH 35 from Dunham Rd to Clarendon Hills Rd and 55th St at Main St | CONST | \$1,120,000 | | | | \$1,120,000 |
| 02-12-0001 | IDOT | IL 68/Dundee Rd at Landwehr Rd | ROW | \$96,000 | | | | \$96,000 |
| 02-12-0005 | IDOT | IL 68/Dundee Rd at Pfungsten Rd | ROW | \$160,000 | | | | \$160,000 |
| 03-12-0001 | IDOT | IL 68/E Dundee Rd at S Barrington Rd | CONST | \$480,000 | | | | \$480,000 |
| 03-12-0003 | IDOT | IL 62/Algonquin Rd at Barrington Rd | ROW | \$80,000 | | | | \$80,000 |
| 03-12-0004 | IDOT | IL 59/Sutton Rd at Stearns Rd | CONST | \$1,200,000 | | | | \$1,200,000 |
| 03-12-0006 | IDOT | Barrington Rd at Bode Rd | CONST | \$320,000 | | | | \$320,000 |
| 03-12-0007 | IDOT | IL 68/Dundee Rd at North Wilke Rd | ROW | \$64,000 | | | | \$64,000 |
| 03-12-0008 | IDOT | IL 68/Dundee Rd at Kennicott Av | CONST | \$280,000 | | | | \$280,000 |
| 03-12-0009 | IDOT | IL 19/Irving Park Rd at IL 59 | CONST | \$280,000 | | | | \$280,000 |
| 03-12-0014 | IDOT | IL 68/Dundee Rd at McHenry Rd/Wheeling Rd | CONST | \$800,000 | | | | \$800,000 |

*Increase, Withdrawal and Obligation codes can be found at the end of this report.

Lines highlighted and shown in italics represent line item status as of prior PSC meeting.

3/26/2013 3:04:29 PM

| TIP ID | Sponsor | Brief Description | Phase | CMAQ \$ (Fed) | Increases* | Withdrawals* | Obligations* | Balance |
|---|------------------------------------|--|-------|---------------------|------------|--------------|--------------|---------------------|
| 03-12-0015 | IDOT | IL 68/Dundee Rd at IL 83 | CONST | \$680,000 | | | | \$680,000 |
| 06-12-0002 | IDOT | IL 43/Harlem Av at 143rd St | ROW | \$160,000 | | | | \$160,000 |
| 06-12-0004 | IDOT | Pulaski Rd at 115th St | ROW | \$160,000 | | | | \$160,000 |
| 06-12-0005 | IDOT | IL 43/Harlem Av at 151st St | ROW | \$160,000 | | | | \$160,000 |
| 08-12-0002 | IDOT | IL 38/Roosevelt Rd at Ardmore Av | ROW | \$160,000 | | | | \$160,000 |
| 08-12-0007 | IDOT | IL 59 at IL 38 (south ramps) | CONST | \$320,000 | | | | \$320,000 |
| 08-12-0013 | IDOT | IL 59 at IL 38 (north ramps) | CONST | \$560,000 | | | | \$560,000 |
| 10-12-0005 | IDOT | IL 68/Dundee Rd at Buffalo Grove Rd | CONST | \$2,000,000 | | | | \$2,000,000 |
| 09-12-0006 | Kane County DOT | Fabyan Pkwy/CH 8 at Kaneville Rd/CH 84 | ENG2 | \$112,000 | | | | \$112,000 |
| 09-12-0011 | Kane County DOT | Fabyan Pkwy/CH 8 at Kirk Rd/CH 77 | ROW | \$280,000 | | | | \$280,000 |
| 09-12-0011 | Kane County DOT | Fabyan Pkwy/CH 8 at Kirk Rd/CH 77 | ENG2 | \$356,000 | | | | \$356,000 |
| 10-00-0129 | Lake County DOT | Hart Rd at US 14/W Northwest Hwy | CONST | \$2,300,000 | | | | \$2,300,000 |
| 10-12-0001 | Lake County DOT | Lake St from Washington St to Belvidere Rd | CONST | \$491,040 | | | | \$491,040 |
| 07-03-0012 | Lan-Oak Park District | Lansing Greenway Connection from Grand Illinois Trail to Thorn Creek Trail | CONST | \$323,014 | | | | \$323,014 |
| 03-12-0010 | Mount Prospect | Golf Rd Alt. 3 Regional Bike Route | CONST | \$272,000 | | | | \$272,000 |
| 04-12-0001 | Oak Park | Madison St from Home Av to Lombard Av | CONST | \$372,000 | | | | \$372,000 |
| 17-12-0001 | Pace | I-90 Corridor Enhanced Markets | IMP | \$10,360,350 | | | | \$10,360,350 |
| 12-12-0003 | Will County Department of Highways | Bell Rd/CH 16 at 143rd St/CH 37 | CONST | \$10,384,000 | | | | \$10,384,000 |
| 38 line items in 2015 totalling: | | | | \$46,133,575 | \$0 | | | \$46,133,575 |

2016

*Increase, Withdrawal and Obligation codes can be found at the end of this report.

Lines highlighted and shown in italics represent line item status as of prior PSC meeting.

3/26/2013 3:04:31 PM

| TIP ID | Sponsor | Brief Description | Phase | CMAQ \$ (Fed) | Increases* | Withdrawals* | Obligations* | Balance |
|------------|--------------------------------|---|-------|---------------|------------|--------------|--------------|-------------|
| 01-06-0005 | CDOT | Walk to Transit - Pedestrian Improvements to Intersections near CTA Rail Stations | IMP | \$100,000 | | | | \$100,000 |
| 01-12-0005 | CDOT | Arterial Detection System Improvements | IMP | \$140,800 | | | | \$140,800 |
| 03-11-0020 | Cook County Highway Department | Lake Cook Rd at 3 IBuffalo Grove Rd, Weiland Rd and IL 83/McHenry Rd. | CONST | \$2,974,000 | | | | \$2,974,000 |
| 03-11-0020 | Cook County Highway Department | Lake Cook Rd at 3 IBuffalo Grove Rd, Weiland Rd and IL 83/McHenry Rd. | CONST | \$5,113,000 | | | | \$5,113,000 |
| 08-12-0003 | Elmhurst | IL 56/Butterfield Rd at York St | CONST | \$1,025,920 | | | | \$1,025,920 |
| 02-12-0001 | IDOT | IL 68/Dundee Rd at Landwehr Rd | CONST | \$480,000 | | | | \$480,000 |
| 02-12-0005 | IDOT | IL 68/Dundee Rd at Pfingsten Rd | CONST | \$640,000 | | | | \$640,000 |
| 03-12-0003 | IDOT | IL 62/Algonquin Rd at Barrington Rd | CONST | \$400,000 | | | | \$400,000 |
| 03-12-0007 | IDOT | IL 68/Dundee Rd at North Wilke Rd | CONST | \$320,000 | | | | \$320,000 |
| 06-12-0002 | IDOT | IL 43/Harlem Av at 143rd St | CONST | \$400,000 | | | | \$400,000 |
| 06-12-0004 | IDOT | Pulaski Rd at 115th St | CONST | \$680,000 | | | | \$680,000 |
| 06-12-0005 | IDOT | IL 43/Harlem Av at 151st St | CONST | \$640,000 | | | | \$640,000 |
| 08-12-0002 | IDOT | IL 38/Roosevelt Rd at Ardmore Av | CONST | \$400,000 | | | | \$400,000 |
| 13-12-0003 | IEPA | Illinois Clean Diesel Engine Repowers | IMP | \$1,000,000 | | \$1,000,000 | T | \$0 |
| 13-12-0003 | IEPA | Illinois Clean Diesel Engine Repowers | IMP | \$1,000,000 | | \$1,000,000 | T | \$0 |
| 13-12-0003 | IEPA | Illinois Clean Diesel Engine Repowers | IMP | \$1,000,000 | | \$1,000,000 | T | \$0 |
| 13-12-0003 | IEPA | Illinois Clean Diesel Engine Repowers | IMP | \$1,000,000 | | \$1,000,000 | T | \$0 |
| 09-12-0006 | Kane County DOT | Fabyan Pkwy/CH 8 at Kaneville Rd/CH 84 | CONST | \$1,083,100 | | | | \$1,083,100 |
| 09-12-0011 | Kane County DOT | Fabyan Pkwy/CH 8 at Kirk Rd/CH 77 | CONST | \$3,846,000 | | | | \$3,846,000 |
| 02-12-0003 | Lincolnwood | Touhy Av Overpass (Skokie Valley Bike Trail) | CONST | \$1,256,000 | | | | \$1,256,000 |

*Increase, Withdrawal and Obligation codes can be found at the end of this report.

Lines highlighted and shown in italics represent line item status as of prior PSC meeting.

3/26/2013 3:04:33 PM

| TIP ID | Sponsor | Brief Description | Phase | CMAQ \$ (Fed) | Increases* | Withdrawals* | Obligations* | Balance |
|---|---------|-------------------|-------|---------------------|------------|--------------------|--------------|---------------------|
| 20 line items in 2016 totalling: | | | | \$23,498,820 | | \$4,000,000 | | \$19,498,820 |

| | | |
|-----------------|---------------------------------|------------------------------------|
| Increases Codes | Withdrawn Codes | Awards/Obligations Codes |
| C - Committee | C - Project Complete | F - Final Voucher/FTA Grant Closed |
| I - Internal | D - Phase Deferred | M - Modified Project Agreement |
| R - Reinstated | O - Obligation Remainder | O - Obligated |
| T - Transfer | S - Sponsor Request | |
| | T - Phase Transfer | |
| | U - Unknown (predates tracking) | |
| | X - Project Transfer | |

*Increase, Withdrawal and Obligation codes can be found at the end of this report.

Lines highlighted and shown in italics represent line item status as of prior PSC meeting.



CMAQ Program Summary - Deferred Projects
Includes obligations through February 28, 2013

| TIP ID | Sponsor | Brief Description | Phase | CMAQ \$ (Fed) | Increases* | Withdrawals* | Obligations* | Balance |
|--|---|--|-------------|------------------|------------------|------------------|--------------------|-----------------|
| 2002 | | | | | | | | |
| 01-01-0011 | CDOT | CDOT-New Resident/Student Bike Marketing Program | ENG | \$119,085 | | | \$119,085 F | \$0 |
| 01-97-0086 | CDOT | CDOT-Near West Side Signal Interconnect | ENG | \$265,513 | \$58,000 C | \$323,513 T | | \$0 |
| 2 line items in 2002 totalling: | | | | \$384,598 | \$58,000 | \$323,513 | \$119,085 | \$0 |
| 2008 | | | | | | | | |
| 09-08-0005 | Carpentersville | IL 31 at Huntley Rd | ENG1 | \$237,600 | | | \$237,025 O | \$575 |
| 01-08-0001 | Forest Preserve District of Cook County | North Branch Bicycle Trail Extension (East Segment) | ENG1 | \$359,000 | | | \$352,562 O | \$6,438 |
| 07-08-0001 | Hazel Crest | S Kedzie Ave from 167th St to 172nd St | ENG1 | \$14,382 | \$32,796 T | | \$47,178 M | \$0 |
| 04-08-0001 | Melrose Park | North Ave Commuter Bicycle Path from Mannheim Rd to Thatcher Ave | ENG1 | \$55,835 | | | \$55,835 O | \$0 |
| 4 line items in 2008 totalling: | | | | \$666,817 | \$32,796 | | \$692,600 | \$7,013 |
| 2009 | | | | | | | | |
| 01-97-0086 | CDOT | CDOT-Near West Side Signal Interconnect | ENG | \$650,487 | \$323,513 T | | \$916,000 M | \$58,000 |
| 09-09-0006 | Elgin | Elgin Bikeway Plan Route 1 NE Quadrant | ENG2 | \$40,300 | \$109,074 R | \$47,974 D | \$101,381 O | \$19 |
| | | | <i>ENG2</i> | <i>\$40,300</i> | <i>\$109,074</i> | <i>\$47,974</i> | <i>\$33,426</i> | <i>\$67,974</i> |
| 2 line items in 2009 totalling: | | | | \$690,787 | \$432,587 | \$47,974 | \$1,017,381 | \$58,019 |
| 2010 | | | | | | | | |
| 11-09-0006 | Crystal Lake | Main St and Crystal Lake Ave Railroad Crossings | ENG1 | \$72,000 | | | \$71,760 M | \$240 |
| 12-10-0001 | Romeoville | 135th St Metra Parking Lot | ENG1 | \$340,000 | | | \$292,400 O | \$47,600 |
| 2 line items in 2010 totalling: | | | | \$412,000 | | | \$364,160 | \$47,840 |

*Increase, Withdrawal and Obligation codes can be found at the end of this report.

Lines highlighted and shown in italics represent line item status as of prior PSC meeting.

| TIP ID | Sponsor | Brief Description | Phase | CMAQ \$ (Fed) | Increases* | Withdrawals* | Obligations* | Balance |
|-------------|-----------------------|---|-------------|------------------|-------------|-----------------|--------------|-----------------|
| 2012 | | | | | | | | |
| 09-08-0005 | Carpentersville | IL 31 at Huntley Rd | ROW | \$260,000 | | \$260,000 | D | \$0 |
| 09-08-0005 | Carpentersville | IL 31 at Huntley Rd | ENG2 | \$190,400 | | \$190,400 | D | \$0 |
| 01-04-0002 | CDOT | 35th St Bicycle-Pedestrian Bridge | CONST | \$6,201,818 | | \$6,201,818 | D | \$0 |
| 01-05-0001 | CDOT | Safe Routes to School Program - Citywide | ENG2 | \$192,000 | \$100,000 T | | \$298,400 O | (\$6,400) |
| 01-05-0001 | CDOT | Safe Routes to School Program - Citywide | ENG2 | \$100,000 | | \$100,000 | T | \$0 |
| | | | <i>ENG2</i> | <i>\$100,000</i> | | <i>\$63,057</i> | | <i>\$36,943</i> |
| | | | <i>ENG2</i> | <i>\$100,000</i> | | <i>\$36,943</i> | | <i>\$63,057</i> |
| 01-06-0074 | CDOT | Chicago Diesel Fleet Retrofit Project | IMP | \$1,739,000 | | \$1,739,000 | D | \$0 |
| 01-06-0074 | CDOT | Chicago Diesel Fleet Retrofit Project | IMP | \$472,800 | \$200,000 C | \$472,800 | D | \$200,000 |
| 01-08-0003 | CDOT | Signal Controller Upgrade and Timing Program | ENG2 | \$320,000 | | \$320,000 | D | \$0 |
| 01-08-0003 | CDOT | Signal Controller Upgrade and Timing Program | IMP | \$1,600,000 | | \$1,600,000 | D | \$0 |
| 01-08-0007 | CDOT | 79th St from IL 50/Cicero Ave to Ashland Ave | CONST | \$5,020,000 | | \$5,020,000 | D | \$0 |
| 01-09-0005 | CDOT | Traffic Management Center Integrated Corridor Management | IMP | \$1,520,000 | | \$1,520,000 | D | \$0 |
| 01-97-0086 | CDOT | CDOT-Near West Side Signal Interconnect | CONST | \$1,692,000 | | \$1,692,000 | D | \$0 |
| 01-97-0088 | CDOT | 87th St from Pulaski Rd to I-94/Dan Ryan Ewy | ENG1 | \$200,000 | | \$200,000 | D | \$0 |
| 01-97-0088 | CDOT | 87th St from Pulaski Rd to I-94/Dan Ryan Ewy | CONST | \$1,670,000 | | \$1,670,000 | D | \$0 |
| 07-01-0004 | Chicago Heights | City of Chicago Heights-Old Plank Road Trail Extension from Western to Euclid | CONST | \$849,450 | | \$849,450 | D | \$0 |
| 01-03-0019 | Chicago Park District | Lakefront Trail Expansion, Ardmore Ave to Sheridan Rd | ENG1 | \$300,000 | | \$300,000 | D | \$0 |
| 01-05-0005 | Chicago Park District | Jackson Park/59th St Bicycle Path | CONST | \$578,000 | | \$578,000 | D | \$0 |

*Increase, Withdrawal and Obligation codes can be found at the end of this report.

Lines highlighted and shown in italics represent line item status as of prior PSC meeting.

3/26/2013 3:45:37 PM

| TIP ID | Sponsor | Brief Description | Phase | CMAQ \$ (Fed) | Increases* | Withdrawals* | Obligations* | Balance |
|---|---|--|-------|---------------------|------------------|---------------------|------------------|------------------|
| 09-09-0006 | Elgin | Elgin Bikeway Plan Route 1 NE Quadrant | CONST | \$297,900 | \$90,100 C | \$388,000 | D | \$0 |
| 01-08-0001 | Forest Preserve District of Cook County | North Branch Bicycle Trail Extension (East Segment) | ENG2 | \$239,000 | | \$239,000 | D | \$0 |
| 07-08-0001 | Hazel Crest | S Kedzie Ave from 167th St to 172nd St | ENG2 | \$7,618 | | \$7,618 | D | \$0 |
| 07-09-0003 | Hazel Crest | Commuter Parking along Park Av from 167th St to 171st St | ENG2 | \$32,320 | | | \$20,880 M | \$11,440 |
| 07-09-0003 | Hazel Crest | Commuter Parking along Park Av from 167th St to 171st St | CONST | \$189,760 | | \$189,760 | D | \$0 |
| 09-08-0003 | Kane County DOT | Main St at Nelson Lake Rd | ROW | \$400,000 | | \$400,000 | S | \$0 |
| 10-02-0007 | Lake Zurich | Lake Zurich-US 12/Rand Road at Ela Road | CONST | \$175,383 | \$148,400 C | \$323,783 | D | \$0 |
| 10-02-0007 | Lake Zurich | Lake Zurich-US 12/Rand Road at Ela Road | CONST | \$275,400 | | \$275,400 | D | \$0 |
| 04-08-0001 | Melrose Park | North Ave Commuter Bicycle Path from Mannheim Rd to Thatcher Ave | ENG2 | \$59,165 | | \$59,165 | D | \$0 |
| 04-08-0002 | Northlake | Grand Ave Sidewalk from Northwest Ave to Rhodes Ave | ENG1 | \$140,000 | | | \$99,737 O | \$40,263 |
| 04-08-0002 | Northlake | Grand Ave Sidewalk from Northwest Ave to Rhodes Ave | ENG2 | \$140,000 | | \$140,000 | D | \$0 |
| 04-08-0002 | Northlake | Grand Ave Sidewalk from Northwest Ave to Rhodes Ave | CONST | \$1,693,000 | | \$1,693,000 | D | \$0 |
| 08-05-0005 | Oak Brook | Oak Brook Employment Area Distributor Service | ENG | \$50,000 | | | \$36,890 O | \$13,110 |
| 06-06-0061 | Palos Heights | Cal Sag Greenway Bike Trail from IL 83 to 127th St | ENG2 | \$440,000 | | \$440,000 | D | \$0 |
| 04-00-0010 | Schiller Park | Des Plaines River Rd Continuous Left Turn Lane from River St to Winona | ENG2 | \$24,000 | | \$24,000 | D | \$0 |
| 32 line items in 2012 totalling: | | | | \$27,069,014 | \$538,500 | \$26,893,194 | \$455,907 | \$258,413 |
| 2013 | | | | | | | | |
| 09-08-0005 | Carpentersville | IL 31 at Huntley Rd | CONST | \$2,636,800 | | \$2,636,800 | D | \$0 |

*Increase, Withdrawal and Obligation codes can be found at the end of this report.

Lines highlighted and shown in italics represent line item status as of prior PSC meeting.

3/26/2013 3:45:38 PM

| TIP ID | Sponsor | Brief Description | Phase | CMAQ \$ (Fed) | Increases* | Withdrawals* | Obligations* | Balance |
|------------|---|---|--------------|------------------|------------------|------------------|--------------|------------------|
| 01-01-0011 | CDOT | CDOT-New Resident/Student Bike Marketing Program | IMP | \$400,000 | | | | \$400,000 |
| 01-01-0011 | CDOT | CDOT-New Resident/Student Bike Marketing Program | IMP | \$786,315 | | | | \$786,315 |
| 01-04-0002 | CDOT | 35th St Bicycle-Pedestrian Bridge | ENG2 | \$838,182 | | | | \$838,182 |
| 01-04-0002 | CDOT | 35th St Bicycle-Pedestrian Bridge | ENG2 | \$195,048 | \$675,630 T | | | \$870,678 |
| 01-05-0001 | CDOT | Safe Routes to School Program - Citywide | CONST | \$692,000 | | \$692,000 D | | \$0 |
| 01-05-0001 | CDOT | Safe Routes to School Program - Citywide | CONST | \$566,543 | \$63,057 T | \$629,600 D | | \$0 |
| 01-06-0074 | CDOT | Chicago Diesel Fleet Retrofit Project | IMP | \$1,118,000 | | \$1,318,000 D | | (\$200,000) |
| 01-08-0007 | CDOT | 79th St from IL 50/Cicero Ave to Ashland Ave | ENG2 | \$440,000 | | | \$68,636 M | \$371,364 |
| 01-09-0002 | CDOT | Weber Spur Trail UPRR from Devon/Springfield to Elston/Kimberly | ENG1 | \$800,000 | | | | \$800,000 |
| 01-97-0088 | CDOT | 87th St from Pulaski Rd to I-94/Dan Ryan Ewy | CONST | \$1,338,000 | | \$1,338,000 D | | \$0 |
| 07-01-0004 | Chicago Heights | City of Chicago Heights-Old Plank Road Trail Extension from Western to Euclid | ENG2 | \$65,000 | | | \$59,026 O | \$5,974 |
| 05-09-0002 | Cicero | Cicero Rail Yard Switch Engine Retrofit | IMP | \$1,820,000 | | \$1,820,000 D | | \$0 |
| 01-08-0001 | Forest Preserve District of Cook County | North Branch Bicycle Trail Extension (East Segment) | CONST | \$3,402,000 | | \$3,402,000 D | | \$0 |
| 01-08-0001 | Forest Preserve District of Cook County | North Branch Bicycle Trail Extension (East Segment) | CONST | \$2,390,000 | | \$2,390,000 D | | \$0 |
| 07-06-0058 | Forest Preserve District of Cook County | Thorn Creek Bicycle Trail Completion | CONST | \$3,805,055 | \$1,117,345 C | | | \$4,922,400 |
| 07-08-0001 | Hazel Crest | S Kedzie Ave from 167th St to 172nd St | CONST | \$133,000 | \$392,000 C | \$525,000 D | | \$0 |
| | | | <i>CONST</i> | <i>\$133,000</i> | <i>\$392,000</i> | <i>\$32,796</i> | | <i>\$492,204</i> |
| | | | <i>CONST</i> | <i>\$133,000</i> | <i>\$392,000</i> | <i>\$492,204</i> | | <i>\$32,796</i> |
| 09-08-0003 | Kane County DOT | Main St at Nelson Lake Rd | ENG2 | \$96,000 | | \$41,000 S | \$54,446 O | \$554 |
| 10-02-0007 | Lake Zurich | Lake Zurich-US 12/Rand Road at Ela Road | ENG2 | \$35,000 | \$35,000 R | \$35,000 D | | \$35,000 |

*Increase, Withdrawal and Obligation codes can be found at the end of this report.

Lines highlighted and shown in italics represent line item status as of prior PSC meeting.

3/26/2013 3:45:39 PM

| TIP ID | Sponsor | Brief Description | Phase | CMAQ \$ (Fed) | Increases* | Withdrawals* | Obligations* | Balance |
|--|-----------------|--|--------------|---------------------|--------------------|---------------------|------------------|--------------------|
| 04-08-0001 | Melrose Park | North Ave Commuter Bicycle Path from Mannheim Rd to Thatcher Ave | CONST | \$1,108,000 | | \$1,108,000 | D | \$0 |
| 08-05-0005 | Oak Brook | Oak Brook Employment Area Distributor Service | IMP | \$910,000 | | \$910,000 | D | \$0 |
| 06-06-0061 | Palos Heights | Cal Sag Greenway Bike Trail from IL 83 to 127th St | ROW | \$20,000 | \$20,000 R | \$20,000 | D | \$20,000 |
| <i>Previously programmed in FFY 2012</i> | | | <i>ROW</i> | <i>\$20,000</i> | | <i>\$20,000</i> | | <i>\$0</i> |
| 06-06-0061 | Palos Heights | Cal Sag Greenway Bike Trail from IL 83 to 127th St | CONST | \$326,000 | | \$326,000 | D | \$0 |
| 06-06-0061 | Palos Heights | Cal Sag Greenway Bike Trail from IL 83 to 127th St | CONST | \$161,000 | \$161,000 R | \$161,000 | D | \$161,000 |
| | | | <i>CONST</i> | <i>\$161,000</i> | | <i>\$161,000</i> | | <i>\$0</i> |
| 12-10-0001 | Romeoville | 135th St Metra Parking Lot | ENG2 | \$440,000 | | \$440,000 | D | \$0 |
| 12-10-0001 | Romeoville | 135th St Metra Parking Lot | CONST | \$812,000 | | \$812,000 | D | \$0 |
| 12-10-0001 | Romeoville | 135th St Metra Parking Lot | CONST | \$2,840,000 | | \$2,840,000 | D | \$0 |
| 04-00-0010 | Schiller Park | Des Plaines River Rd Continuous Left Turn Lane from River St to Winona | CONST | \$320,000 | | \$320,000 | D | \$0 |
| 09-10-0002 | Sleepy Hollow | Bike Path along Sleepy Hollow Road from Thorbred Lane to Dundee Township Bird Sanctuary Trail Head | ENG2 | \$9,600 | | | \$9,600 M | \$0 |
| 09-10-0002 | Sleepy Hollow | Bike Path along Sleepy Hollow Road from Thorbred Lane to Dundee Township Bird Sanctuary Trail Head | CONST | \$72,000 | \$72,000 R | \$72,000 | D | \$72,000 |
| | | | <i>CONST</i> | <i>\$72,000</i> | | <i>\$72,000</i> | | <i>\$0</i> |
| 07-06-0002 | University Park | Cicero Ave Shared Use Path | ENG1 | \$60,000 | \$60,000 R | \$60,000 | D | \$60,000 |
| 07-06-0002 | University Park | Cicero Ave Shared Use Path | ENG2 | \$14,000 | | \$14,000 | D | \$0 |
| 32 line items in 2013 totalling: | | | | \$28,649,543 | \$2,596,032 | \$21,910,400 | \$191,708 | \$9,143,467 |
| 2014 | | | | | | | | |
| 01-01-0011 | CDOT | CDOT-New Resident/Student Bike Marketing Program | IMP | \$2,000,000 | | \$2,000,000 | D | \$0 |

*Increase, Withdrawal and Obligation codes can be found at the end of this report.

Lines highlighted and shown in italics represent line item status as of prior PSC meeting.

3/26/2013 3:45:40 PM

| TIP ID | Sponsor | Brief Description | Phase | CMAQ \$ (Fed) | Increases* | Withdrawals* | Obligations* | Balance |
|--|-----------------|--|-------|--------------------|------------------|--------------------|--------------|------------|
| 01-09-0002 | CDOT | Weber Spur Trail UPRR from Devon/Springfield to Elston/Kimberly | ENG2 | \$560,000 | | \$560,000 | D | \$0 |
| 01-09-0002 | CDOT | Weber Spur Trail UPRR from Devon/Springfield to Elston/Kimberly | IMP | \$880,000 | | \$880,000 | D | \$0 |
| 09-08-0003 | Kane County DOT | Main St at Nelson Lake Rd | CONST | \$1,120,000 | | \$1,120,000 | D | \$0 |
| 07-06-0002 | University Park | Cicero Ave Shared Use Path | CONST | \$184,800 | | \$184,800 | D | \$0 |
| 07-96-0003 | University Park | University Parkway Bike Facility and Intersection Improvement at Governors Highway | CONST | \$248,000 | \$86,800 C | \$334,800 | D | \$0 |
| 07-96-0003 | University Park | University Parkway Bike Facility and Intersection Improvement at Governors Highway | CONST | \$550,000 | \$775,200 C | \$1,325,200 | D | \$0 |
| 7 line items in 2014 totalling: | | | | \$5,542,800 | \$862,000 | \$6,404,800 | | \$0 |
| 2015 | | | | | | | | |
| 11-09-0006 | Crystal Lake | Main St and Crystal Lake Ave Railroad Crossings | CONST | \$938,000 | | \$938,000 | D | \$0 |
| 1 line items in 2015 totalling: | | | | \$938,000 | | \$938,000 | | \$0 |

| | | |
|-----------------|---------------------------------|------------------------------------|
| Increases Codes | Withdrawn Codes | Awards/Obligations Codes |
| C - Committee | C - Project Complete | F - Final Voucher/FTA Grant Closed |
| I - Internal | D - Phase Deferred | M - Modified Project Agreement |
| R - Reinstated | O - Obligation Remainder | O - Obligated |
| T - Transfer | S - Sponsor Request | |
| | T - Phase Transfer | |
| | U - Unknown (predates tracking) | |
| | X - Project Transfer | |

*Increase, Withdrawal and Obligation codes can be found at the end of this report.

Lines highlighted and shown in italics represent line item status as of prior PSC meeting.



CMAQ Programming Summary and Obligation Goals

| FFY | Currently Programmed | Federal Apportionment | Unobligated | Unprogrammed Balance | Obligation Goal | Current FFY Obligations to Date | Obligations Needed to Meet Goal |
|------|----------------------|-----------------------|----------------|----------------------|-----------------|---------------------------------|---------------------------------|
| 2013 | \$ 204,984,625 | \$ 105,624,509 | \$ 225,281,090 | \$ 20,296,465 | \$ 122,971,344 | \$ 50,530,893 | \$ 72,440,451 |
| 2014 | \$ 72,163,111 | \$ 106,744,625 | | \$ 34,581,514 | \$ 138,600,323 | | |
| 2015 | \$ 46,133,575 | \$ 106,744,625 | | \$ 60,611,050 | \$ 145,988,364 | | |
| 2016 | \$ 19,498,820 | \$ 106,744,625 | | \$ 87,245,805 | \$ 145,988,364 | | |

Current as of 2/28/13.

Currently Programmed: Net amounts programmed (withdrawn and obligated funds not included). FFY 2013 includes amounts from in prior years. Source: CMAQ database

Federal Apportionment: Amount apportioned to the state based on CMAQ distribution formula and Congressional appropriation. Northeastern Illinois is allocated 95.21% of the state apportionment; the full apportionment is used for a programming mark. FFY 2014-2016 apportionments are estimates. Source: FHWA FMIS database

Unobligated: Amount of apportioned funds that are unobligated for the state. Northeastern Illinois is a portion of this. Source: FHWA FMIS database

Unprogrammed Balance: For current year, currently programmed less unobligated; for future years, apportionment less programmed. The funds that are available to program as of the current date

Obligation Goal: Goals to obligate the apportioned amount plus a fraction of the unobligated balance to achieve a zero unobligated balance over four years. Source: August 28, 2012 CMAQ Project Selection Committee meeting.

Current FFY Obligations to Date: Obligations (Federal Authorizations) through the "current as of" date. Projects in advance construction are included. Source: CMAQ database

Obligations Needed to Meet Goal: Obligation Goal less Current FFY Obligations to Date.



MEMORANDUM

To: CMAQ Project Selection Committee
From: CMAP Staff
Date: April 4, 2013
Re: CMAQ Transit Project Expenditure Updates – 4th Calendar Quarter of 2012

Staff conducted the 4th quarter of 2012 Transit Expenditure Update (Oct-Dec). This effort is intended to track transit project expenditures after each project has been obligated. Of the 57 transit projects reported on this quarter, 13 are complete, but not closed out. Twenty projects have not expended any CMAQ funds yet. The table below summarizes the agencies’ responses and provides federal dollars expended, unexpended balances, and the percent of obligated CMAQ funds expended on each agency’s projects (excluding completed projects) to show the degree to which active projects are yet to be undertaken.

Summary of CMAQ Transit Project Expenditures Updates – 4th Quarter 2012

| Agency | # of Projects | # of completed projects (but not closed) | # of new "close outs" | # of Active Projects w/ zero expenditures | Combined % expended on incomplete projects | Federal Dollars expended on incomplete projects | Remaining Balance on incomplete Projects (Federal Dollars) | # "stalled-unclear" projects |
|---------------|---------------|--|-----------------------|---|--|---|--|------------------------------|
| RTA | 8 | 1 | 0 | 2 | 9.3% | 4,402,522 | 42,896,062 | 0 |
| CTA | 13 | 1 | 0 | 6 | 10.1% | 2,425,373 | 21,583,468 | 0 |
| Metra | 14 | 4 | 0 | 8 | 30.3% | 4,411,703 | 10,134,547 | 0 |
| Pace | 11 | 3 | 0 | 4 | 77.0% | 50,509,356 | 15,080,930 | 0 |
| CDOT | 11 | 4 | 1 | 0 | 3.5% | 3,977,895 | 109,766,105 | 1 |
| Totals | 57 | 13 | 1 | 20 | -- | 65,726,849 | 199,461,112 | 1 |

Down from two in the last reporting period, only one project remains stalled: CDOT’s Carroll Avenue Busway (TIP ID 01-04-0004) for \$1.6 million, for which the city is planning to submit a request to the CMAQ Committee to re-scope the project (remaining funds = approx. \$1.588 million).

###

**MEMORANDUM**

To: CMAQ Project Selection Committee

From: CMAP Staff

Date: April 11th, 2013

Re: CMAQ Project Change Requests

Five projects have submitted requests for approval. Four projects requested cost increases for \$17,560,750 total (\$12,564,600 federal). One project requested a scope change. The sponsors' requests are attached.

For Committee Consideration:**Melrose Park – North Ave Commuter Bicycle Path from Mannheim Rd to Thatcher Ave (TIP ID 04-08-0001)**

The sponsor is requesting a scope change. The request is for a revision to the path routing for the west terminus. Currently the west terminus is at Mannheim Rd and North Ave. The sponsor is requesting to change the bicycle path route and the west terminus to Armitage Ave and Mannheim Rd. This project is currently in deferred status. If approved, the project sponsor would then request to be taken off deferred status. It is anticipated that Phase II engineering would be awarded in 2013 with an anticipated letting date in 2014. This project is currently programmed (including the deferred amounts) for \$1,529,000 total (\$1,223,000 federal) with phase II engineering at \$74,085 total (\$59,165 federal) and construction at \$1,385,000 (\$1,108,000 federal). A cost increase is not being sought.

Recommendation to the CMAQ Project Selection Committee:

Consider approval of the scope change to the bicycle path along with a new west terminus at Armitage Ave and Mannheim Rd for Melrose Park – North Ave Commuter Bicycle Path from Mannheim Rd to Thatcher Ave (TIP ID 04-08-0001).

Lake Zurich – Lake Zurich-US 12/Rand Rd at Ela Rd. (TIP ID 10-02-0007)

The sponsor is requesting a cost increase in the amount of \$63,750 total (\$51,000 federal) for Phase II engineering. This project is currently programmed for \$660,500 total (\$528,400 federal) after receiving a cost increase of \$185,161 total (\$148,400 federal) in 2005.

If the cost increase is granted the programmed amount would increase to \$724,250 total (\$579,400 federal) with the Phase II engineering increasing from \$43,750 total (\$35,000 federal) to \$107,500 total (\$86,000 federal).

A reranking was completed with the project ranking remaining unchanged at 3rd among 2005 intersection improvements.

Recommendation to the CMAQ Project Selection Committee:

Consider approval of the cost increase of \$63,750 total (\$51,000 federal) for a project cost of \$724,250 total (\$579,400 federal) for Lake Zurich – Lake Zurich-US 12/Rand Rd at Ela Rd. (TIP ID 10-02-0007).

Sleepy Hollow – Bike Path along Sleepy Hollow Road from Thorobred Lane to Dundee Township Bird Sanctuary Trail Head (TIP ID 09-10-0002)

The sponsor is requesting a cost increase in the amount of \$42,000 total (\$33,600 federal) and to have construction restored from the deferral list. This project was programmed in 2010 for \$114,000 total (\$91,200 federal). The sponsor has indicated that revised cost estimates are the reason for the cost increase.

If the cost increase is granted the total project cost would increase to \$156,000 total (\$124,800 federal). A reranking was completed with the project ranking changing from 5th to 7th among Bicycle Facility proposals in the 2010 program. This is lower than one unfunded proposal, but higher than six others that did receive funding. The sponsor demonstrated that the construction phase is ready by submitting pre-final plans to IDOT. An administrative change was then made to restore construction funds that had been deferred.

Recommendation to the CMAQ Project Selection Committee:

Consider approval of the cost increase of \$42,000 total (\$33,600 federal) for a project cost of \$156,000 total (\$124,800 federal) for Sleepy Hollow – Bike Path along Sleepy Hollow Road from Thorobred Lane to Dundee Township Bird Sanctuary Trail Head (TIP ID 09-10-0002).

IEPA – Norfolk Southern Railway Co Switchyard Diesel Locomotive Retrofit Project (TIP ID 13-10-0005)

The sponsor is requesting a cost increase and in the amount of \$17,260,000 total (\$12,324,000 federal) and scope change to purchase an additional 12 switcher locomotives. The sponsor has indicated that the cost increase is necessary to ensure that the retrofit work can be done in 2015. The sponsor does have an application pending for the current call for projects that would be withdrawn if the cost increase is granted.

If the cost increase is granted the total project cost would increase to \$24,160,000 total (\$15,704,000 federal). The project was reanalyzed and the cost per kilogram of PM eliminated decreased from \$440 to \$308 and the ranking changed to 3rd among 2010 Direct Emissions Reduction projects.

Recommendation to the CMAQ Project Selection Committee:

Consider the cost increase of \$17,260,000 total (\$12,324,000 federal) and scope change to purchase an additional 12 switcher locomotives for a project cost of \$24,160,000 total (\$15,704,000 federal) for IEPA – Norfolk Southern Railway Co Switchyard Diesel Locomotive Retrofit Project (TIP ID 13-10-0005).

Rolling Meadows – Arlington Park Train Station Bicycle Lane Extension (TIP ID 03-08-0004)

The sponsor is requesting a cost increase in the amount of \$195,000 total (\$156,000 federal/CMAQ) for Right of Way (ROW) acquisition. The increase being sought stems from increased per square foot cost from the Union Pacific Railroad for the parcels being acquired for this project. This project was programmed in 2008 for \$715,000 total (\$572,000 federal/CMAQ). This project is currently programmed at \$2,181,786 (\$802,771 Federal) after receiving a cost increase of \$147,534 total (\$63,771 federal/CMAQ) in 2013. Other federal funds (STP-L) are also being used on this project. ROW had previously been obligated for \$100,000 total (\$80,000 federal).

The request from the sponsor indicates that the CMAQ funded portion would be \$958,771. If the cost increase is granted the programmed amount would increase to \$2,376,786 total (\$958,771 federal/CMAQ).

A reranking was completed with the project ranking remaining unchanged at 19th among 2008 Bicycle Facility projects.

Recommendation to the CMAQ Project Selection Committee:

Consider approval of the cost increase of \$195,000 total (\$156,000 federal/CMAQ) for a project cost of \$2,376,786 total (\$958,771 federal/CMAQ) for Rolling Meadows - Arlington Park Train Station Bicycle Lane Extension (TIP ID 03-08-0004).

Ronald M. Serpico
MAYOR

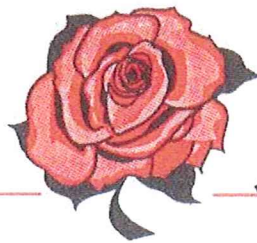

Village of Melrose Park



Mary Ann Paolantonio Salemi
CLERK

Anthony N. Abruzzo
Arturo J. Mota

-- **TRUSTEES** --
Jaime Anguiano
Anthony J. Prignano

Cathy Cossident Italia
Mary Ramirez Taconi

February 15, 2013

Mr. Len Cannata
West Central Municipal Conference
2000 Fifth Avenue - Building N
River Grove, IL 60171

Re: Village of Melrose Park
North Avenue Commuter Bicycle Path
Section 08-00110-00-BT
TIP #: 04-08-0001
Routing Revision
Request for CMAP Approval

Dear Mr. Cannata:

The Village of Melrose Park looks forward to the installation of the North Avenue Commuter Bicycle Path. The proposed bicycle path will traverse the Village in its entirety from east to west, and will be an effective resource to the Village. At this time, we are requesting formal approval, from the Chicago Metropolitan Agency for Planning (CMAP) of the revision to the path routing at the west end.

FHWA/IDOT Local Agency Coordination Meetings were held on April 13, 2010, and August 10, 2010. The meetings had discussions with regards to the western terminus for the path. The planned west terminus at Mannheim Road and North Avenue was discussed at length at the first coordination meeting, and determined to be unfeasible.

As a result, at the second coordination meeting, several options were discussed as an alternative to the planned west terminus at Mannheim Road and North Avenue. The alternatives included routes to reach a signalized intersection at Mannheim Road. The chosen alternative is for the path to run along North Avenue to Cornell Avenue and then turn north along Cornell Avenue and then travel west along Armitage Avenue, ultimately reaching the signalized intersection at Armitage Avenue and Mannheim Road. This routing was approved at the coordination meeting pending approval from CMAP. A location map has been included for your use.

We look forward to receiving CMAP approval of the revised routing to Mannheim Road.

Very Truly Yours,

THE VILLAGE OF MELROSE PARK

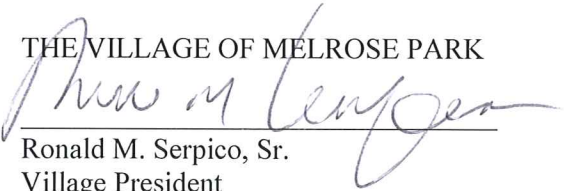
Ronald M. Serpico, Sr.
Village President

Enclosures

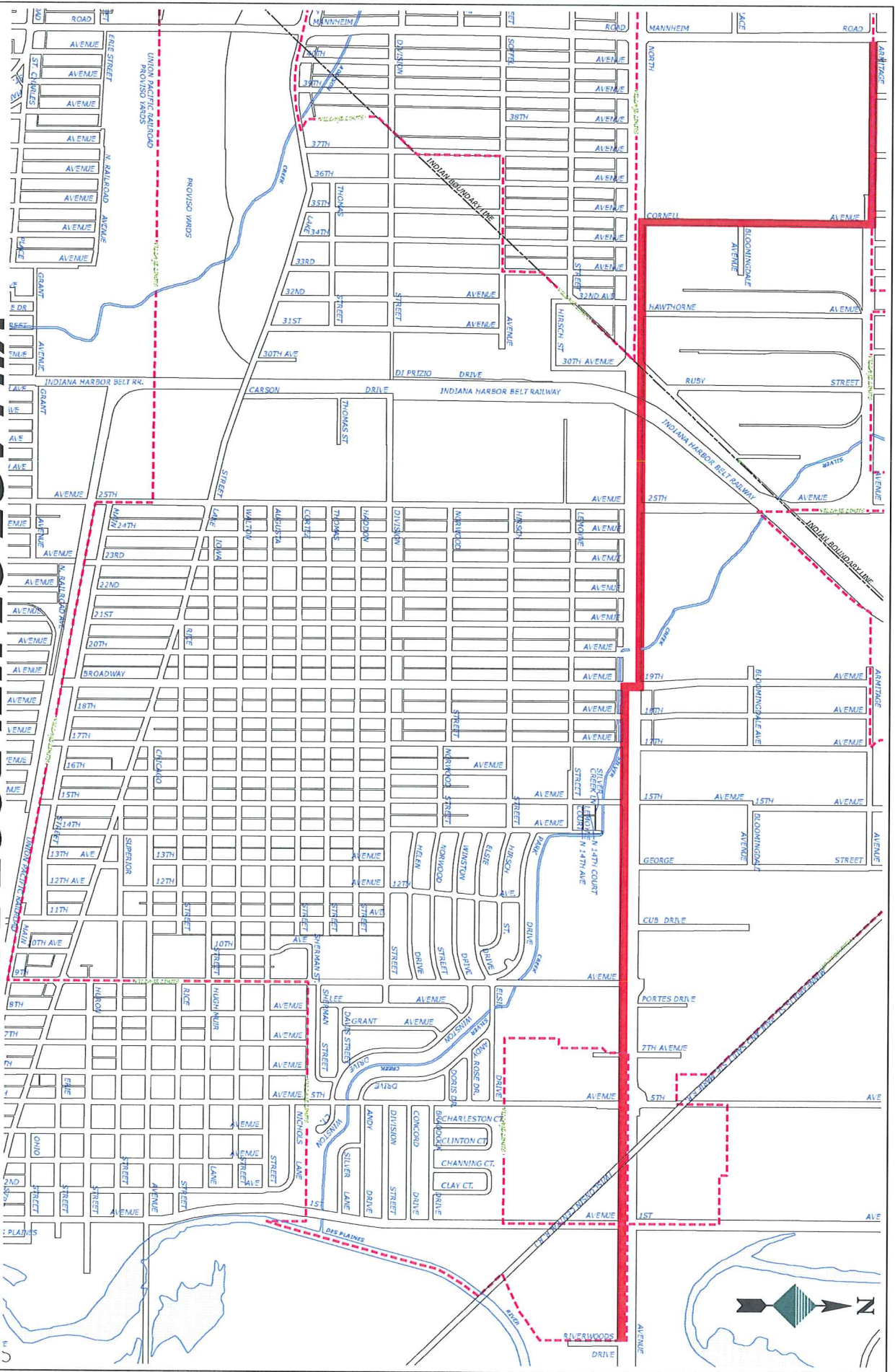

NORTH AVENUE COMMUTER BICYCLE PATH

VILLAGE OF MELROSE PARK

Doug Ferguson

From: Christensen, Bruce D. <BChristensen@lakecountyil.gov>
Sent: Wednesday, February 13, 2013 8:22 AM
To: Doug Ferguson
Cc: Chad Riddle
Subject: 10-02-0007

Doug-

The Village of Lake Zurich is requesting that CMAQ funds in the amount of \$51,000 be reallocated from construction to engineering II for this project. This request is made to coincide with the engineering II consultant agreement costs being reviewed by IDOT BLRS.

Bruce D. Christensen
Transportation Coordinator
Lake County Division of Transportation
600 Winchester Road
Libertyville, IL 60048
(847) 377-7455
bchristensen@lakecountyil.gov

Chicago Area Transportation Study

CMAQ Cost Increase Analysis

TIP ID: **10-02-0007**

Description: **Lake Zurich-US 12/Rand Road at Ela Road**

Ranking Computation

| | 2002 Award | 2005 Award | 2005 Increase | 2013 Increase |
|-----------------------|------------|--------------|---------------|---------------|
| Tons VOC eliminated | 12.2101 | 0.0873 | 3.1145 | 3.1145 |
| Cost | \$ 316,339 | \$ 159,000 | \$ 660,500 | \$ 724,250 |
| \$/Ton VOC eliminated | \$ 25,880 | \$ 1,820,543 | \$ 212,073 | \$ 232,541 |
| Rank | 1 | 9 | 3 | 3 |

Project Expenses

| | Federal Share | Total | Fed % | Basis |
|------------------|---------------|------------|-------|---------------------|
| '02 + '05 Awards | \$ 380,000 | \$ 475,339 | 79.9% | Approved Project |
| 2005 Increase | \$ 528,400 | \$ 660,500 | 80.0% | Letter from Sponsor |
| 2013 Increase | \$ 579,400 | \$ 724,250 | 80.0% | Letter from Sponsor |
| Increase Amount | \$ 51,000 | \$ 63,750 | | |

Notes: The 2002 and 2005 awards were for different portions of the project and the portions were analyzed separately. Using updated methods, an abbreviated analysis was conducted for the entire project.

FY 2005 CMAQ Program

| ID | Facility to be Improved | Total \$ | Fed \$ | \$/Ton Voc | Select |
|---------------------------------|--|--------------|--------------|---------------|-------------|
| Intersection Improvement | | | | | |
| II03052489 | Palatine-Palatine Rd from Smith St to US 14/Northwest Hwy | \$3,368,000 | \$2,694,000 | \$155,774 | \$2,694,000 |
| II11052336 | McHenry-IL 31 from McCullom Lake Rd to IL 120 | \$3,175,000 | \$2,540,000 | \$178,043 | \$2,540,000 |
| Revised Rank 1 | | | | \$212,073 | |
| Revised Rank 2 | | | | \$232,541 | |
| II02052465 | Wilmette-Green Bay Rd from Lake Ave to Linden Ave | \$921,000 | \$737,000 | \$283,261 | \$737,000 |
| II01052435 | CDOT-Grand Ave from Long Ave to North Ave | \$1,465,000 | \$1,172,000 | \$286,959 | |
| II09052427 | Kane County DOT-Kirk Rd and IL 56 | \$2,088,000 | \$1,670,000 | \$787,397 | \$500,000 |
| II09052431 | Kane County DOT-Orchard Rd and Jericho Rd | \$1,999,400 | \$1,599,500 | \$1,039,853 | \$1,100,000 |
| II01052451 | CDOT-Milwaukee Ave Signal Modernization from Higgins Rd to Montrose Ave | \$1,500,000 | \$1,200,000 | \$1,247,525 | |
| II10052354 | Lake County DOT-Hunt Club Rd at Wadsworth Rd | \$850,000 | \$680,000 | \$1,380,689 | \$680,000 |
| II10052350 | Lake Zurich-US 12/Rand Rd at Ela Rd | \$159,000 | \$127,000 | \$1,820,543 | \$127,000 |
| II10052317 | Grayslake-Atkinson Rd Extension | \$23,313,000 | \$16,708,000 | \$2,349,700 | |
| II10052353 | Lake County DOT-Hunt Club Rd at Millburn Rd | \$940,000 | \$752,000 | \$2,646,080 | \$752,000 |
| II12052357 | Romeoville-IL 53/Independence Blv at University Pwy | \$677,000 | \$542,000 | \$2,699,834 | |
| II11052365 | McHenry County Highway Department-Rakow Rd at Pyott Rd | \$1,896,000 | \$1,517,000 | \$3,228,372 | |
| II10052464 | Vernon Hills-Fairway Dr and IL 60 | \$2,083,000 | \$1,666,400 | \$4,090,421 | |
| II08052349 | Glen Ellyn-IL 38/Roosevelt Rd at Lambert Rd | \$332,000 | \$265,600 | \$4,160,818 | |
| II01052483 | CDOT-Chicago Ave Signal Modernizations/Intersection Improvements from Laramie Ave to Sacramento Blv | \$4,347,600 | \$3,478,080 | \$4,191,921 | |
| II03052467 | Schaumburg-Barrington Rd from Schaumburg Rd to Holmes Way | \$1,616,200 | \$1,292,900 | \$4,389,160 | |
| II07052308 | South Holland-State St at 168th St | \$1,320,000 | \$1,056,000 | \$5,943,536 | |
| II03052490 | Rolling Meadows-IL 58/Golf Rd at IL 62/Algonquin Rd | \$500,000 | \$400,000 | \$6,295,635 | |
| II12052492 | Joliet-Essington Rd and Hennepin Dr | \$440,000 | \$352,000 | \$6,471,088 | |
| II08052456 | Naperville-US 34/Ogden Ave from Iroquois Ave to Fender Rd and Naper Blvd from Ridgeland Rd to Old Plank Rd | \$522,400 | \$417,900 | \$6,524,218 | |
| II10052452 | Lake County DOT-IL 176 and Fairfield Rd | \$3,434,000 | \$2,748,000 | \$7,999,312 | |
| II06052462 | Orland Park-US 45/LaGrange Rd and 143rd St | \$1,992,000 | \$1,594,000 | \$8,638,174 | |
| II11052334 | Crystal Lake-Pingree Rd at US14/Northwest Hwy | \$1,111,000 | \$889,000 | \$9,621,499 | |
| II11052361 | McHenry County Highway Department-Rakow Rd at IL 31 | \$1,530,000 | \$1,224,000 | \$11,845,368 | |
| II04052338 | Forest Park-Des Plaines Ave at Randolph St | \$480,000 | \$384,000 | \$12,446,367 | |
| II10052306 | Gurnee-Cemetery Rd at Washington St | \$3,950,000 | \$3,160,000 | \$15,616,824 | |
| II10052352 | Lake County DOT-IL 131/Green Bay Rd at Wadsworth Rd | \$3,680,000 | \$2,920,000 | \$46,250,468 | |
| II12052469 | Will County Department of Highways-Laraway Rd at Cedar Rd | \$572,500 | \$458,000 | \$157,957,903 | |
| II02052453 | Glenview-Golf Rd and Shermer Rd | \$609,512 | \$487,610 | No Benefit | |
| II04052337 | Forest Park-Circle Ave at Harrison St | \$280,000 | \$224,000 | No Benefit | |
| II09052330 | South Elgin-State St from Spring St and Collins St to Water St | \$2,503,000 | \$2,002,000 | No Benefit | |
| II09052331 | South Elgin-Gilbert St from State St to Middle St | \$2,195,000 | \$1,756,000 | No Benefit | |
| II09052335 | Oswego-Douglas Rd from US 34 to US 30 | \$916,669 | \$733,335 | No Benefit | |
| II09052413 | Kane County DOT-Mooseheart Rd and IL 31 | \$1,305,650 | \$1,044,520 | No Benefit | |
| II09052425 | Kane County DOT-Silver Glen Rd and IL 31 | \$1,698,000 | \$1,358,000 | No Benefit | |
| II09052426 | Kane County DOT-Farnsworth Ave and 5th Ave | \$3,094,000 | \$2,475,000 | No Benefit | |
| II12052332 | New Lenox-Cedar Rd at Joliet Hwy | \$968,000 | \$774,400 | No Benefit | |
| II12052333 | New Lenox-Cedar Rd at Francis Rd | \$1,370,000 | \$1,096,000 | No Benefit | |
| II12052351 | Lockport-IL 171/State St at 13th St | \$910,500 | \$728,400 | No Benefit | |
| II12052471 | Will County Department of Highways-Laraway Rd and Center Rd | \$562,500 | \$450,000 | No Benefit | |
| II01052448 | CDOT-87th St from Eggleston Ave to Chatham Ridge Driveway | \$2,582,500 | \$2,066,000 | Not Analyzed | |



The Village of Sleepy Hollow, IL

One Thorobred Lane
Sleepy Hollow, IL 60118

| | | | |
|---------------------|--------------|-------------------|--------------|
| Village President | 847.426.9638 | Village Clerk | 847.428.2266 |
| Village Hall | 847.426.6700 | Police Department | 847.426.4425 |
| Building Department | 847.428.3388 | FAX | 847.426.4082 |

Mr. Doug Ferguson
Chicago Metropolitan Agency for Planning (CMAP)
233 South Wacker Drive, Suite 800
Chicago, IL 60606

Re: Sleepy Hollow Bicycle Path
Revised Funding Request
TIP ID Number 09-10-0002
Project No: SH-1218

Dear Mr. Ferguson,

The Village of Sleepy Hollow is requesting an increase to CMAQ funding for the Sleepy Hollow Bicycle Path (09-10-0002). The requested funding increase is for \$33,600 as indicated in the following table:

| Phase | Federal Project Number | Current CMAQ Funding (80%) | Revised CMAQ Funding (80%) | Current Local Funding (20%) | Revised Local Funding (20%) |
|--------------------------|------------------------|----------------------------|----------------------------|-----------------------------|-----------------------------|
| Eng 1 | CMM-9003(579) | \$9,600.00 | \$9,600.00 | \$2,400.00 | \$2,400.00 |
| Eng 2 | CMM-9003(580) | \$9,600.00 | \$9,600.00 | \$2,400.00 | \$2,400.00 |
| Const | CMM-9003(581) | \$63,200.00 | \$96,000.00 | \$15,800.00 | \$24,000.00 |
| Construction Engineering | | \$8,800.00 | \$9,600.00 | \$2,200.00 | \$2,400.00 |
| Total | | \$91,200.00 | \$124,800.00 | \$22,800.00 | \$31,200.00 |

The original estimate was generated in 2009 and after going through Phase 1 and Phase 2 and adjusting for annual cost increases we find the need to request an increase to the approved funding for this project.

We respectfully request that the cost increase from \$91,200 to \$124,800 to be incorporated into the CMAQ program. Should you have any questions in regards to this matter please contact Jeff Steele, Gerald Heinz & Assoc., at 847-426-4535 or jsteele@glheinzinc.com

Sincerely,

Stephan K. Pickett
Village President

Chicago Metropolitan Agency for Planning

CMAQ Cost Increase Analysis

TIP ID: **09-10-0002**

Description: **Bike Path along Sleepy Hollow Rd from Thorobred Ln to Dundee Township Bird Sanctuary Trail Head.**

Ranking Computation

| | 2010 | 2013 |
|-----------------------|------------|------------|
| Tons VOC eliminated | 174.6312 | 174.6312 |
| Cost | \$ 114,000 | \$ 156,000 |
| \$/Ton VOC eliminated | \$ 653 | \$ 893 |
| Rank | 5 | 7 |

Project Expenses

| | Federal Share | Total | Fed % |
|-----------------|---------------|------------|-------|
| 2010 | \$ 91,200 | \$ 114,000 | 80.0% |
| 2013 | \$ 124,800 | \$ 156,000 | 80.0% |
| Increase Amount | \$ 33,600 | \$ 42,000 | |

Chicago Metropolitan Agency for Planning

FY 2010 CMAQ

Reranking of project 09-10-0002: Bike Path along Sleepy Hollow Rd from Thorobred Ln to Dundee Township Bird Sanctuary Trail Head.

FY 2010 CMAQ Program - Bicycle Facilities

| Sponsor | Facility to be Improved | Project Total | Proposed Program | \$ Per Kilo VOC Eliminated |
|---|--|---------------|------------------|----------------------------|
| Oak Park | Augusta St bike lane from IL 43/Harlem Ave to Austin Blv | \$54,000 | \$43,200 | 13 |
| Oak Park | Division St from IL 43/Harlem Ave to Austin Blv -- on-street facility | \$48,000 | \$38,400 | 49 |
| Oak Park | Chicago Ave bike lane from IL 43/Harlem Ave to Austin Blv | \$82,400 | \$65,900 | 75 |
| Arlington Heights | McDonald Creek Bike Path Improvements (sidepath and park path) | \$320,000 | \$242,000 | 318 |
| Sleepy Hollow | Bike Path (multiuse sidepath) Parallel to Sleepy Hollow Rd south to Township Property | \$114,000 | \$91,200 | 653 |
| Lincolnwood | Lincolnwood Commonwealth Edison (ComEd) Utility ROW / Skokie Valley Bike/Multiuse Trail | \$1,020,000 | \$816,000 | 686 |
| Des Plaines | Des Plaines River Trail Improvements from Touhy Ave to Algonquin Rd | \$994,600 | \$0 | 740 |
| Revised Rank | | | | 893 |
| Hoffman Estates | Harmon Blv / Huntington ROW / Huntington Blv from Bode Rd to Hassell Rd | \$402,000 | \$0 | 998 |
| Arlington Heights | Creekside Park Bike Path (sidepath and park path) | \$310,000 | \$0 | 1133 |
| Grayslake | Washington St Bike Path (sidepath) | \$950,600 | \$760,480 | 1203 |
| Schaumburg | Martingale Road Bikeway | \$1,567,000 | \$0 | 2029 |
| Carol Stream | Fair Oaks Rd Sidepath from St Charles Rd to Oxford St | \$1,939,250 | \$0 | 2297 |
| Rolling Meadows | Rolling Meadows-Euclid Ave Bike Path From Plum Grove Road to Hicks Road | \$442,000 | \$0 | 2313 |
| Mundelein | Mundelein Bike (Multiuse) Trail System sidepath (Butterfield Rd) | \$417,400 | \$0 | 2534 |
| Lakewood | Huntley Rd Bikepath Improvements (on-street bike lanes) | \$939,000 | \$0 | 2543 |
| Lockport | Division St / Farrell Rd Bicycle and Pedestrian facility Improvement Project (from Briggs St w to Farrell, then north to 7th st) | \$341,500 | \$0 | 2557 |
| Rolling Meadows | Quentin Rd Bike Path from Silentbrook Ln to Hartung Rd | \$730,000 | \$0 | 2714 |
| Homer Glen | Homer Glen Community Trail - South Extension | \$1,521,000 | \$0 | 3126 |
| Wilmette | Skokie Valley Trail from Lake Cook Rd to Old Orchard Rd | \$4,727,000 | \$0 | 3328 |
| Rolling Meadows | Euclid Ave Bike Path from Rohlwing Rd to Salt Creek Ln | \$597,000 | \$0 | 3691 |
| Yorkville | IL 47/Bridge St sidepath from IL 71 to Kennedy Rd | \$909,120 | \$0 | 3729 |
| Hoffman Estates | I-90 Bicycle/Pedestrian Underpass at CN Railroad ROW | \$437,000 | \$0 | 3974 |
| Bensenville | Redmond Park Bike-Ped Path Improvements | \$551,200 | \$0 | 4086 |
| Mount Prospect | Bike/Ped Bridge across US 14 (Northwest Highway) and Union Pacific RR tracks | \$2,909,500 | \$0 | 4176 |
| Orland Park | Commuter & Bicycle Bridge over LaGrange Rd/US 45 at IL 7/Southwest Hwy | \$1,446,000 | \$664,000 | 4340 |
| Lake County | Prairie Crossing Bike Path/Midlothian Rd sidepath | \$2,629,788 | \$2,044,800 | 4466 |
| McHenry County Conservation District | Oak St to Veterans Acres Park Bikepath (multi-use) | \$1,409,000 | \$440,960 | 4599 |
| Carpentersville | Maple Ave from Washington St to L W Besinger Dr | \$947,000 | \$0 | 4962 |
| Glenview | Techy Trail Segment 4 - Two Sections | \$455,000 | \$0 | 5396 |
| Minooka | Wapella St Bike Path from Wabena St to Rivers Edge Dr | \$225,150 | \$0 | 5523 |
| Lincolnwood | Lincolnwood Union Pacific (UP) Rail Line/Weber Spur Bike/Multiuse Trail | \$6,135,000 | \$4,908,000 | 5553 |
| CDOT | Lakefront Trail-Navy Pier Flyover | \$28,335,500 | \$13,696,000 | 5754 |
| Yorkville | US 34/Veterans Prk sidepath from Center Prk to Eldamain Rd | \$970,975 | \$0 | 5774 |
| Romeoville | Bike (Multiuse) Path in ComEd ROW connecting Romeoville and Plainfield | \$1,865,000 | \$0 | 5895 |
| Crystal Lake | Pingree Rd Segment 3 Bike Path | \$375,000 | \$0 | 8370 |
| Yorkville | Kennedy Road sidepath from Bailey Rd to IL 47/Bridge St | \$161,800 | \$0 | 10298 |
| Kane County DOT | Stearns Road Bicycle and Pedestrian Bridge | \$2,959,400 | \$0 | 13028 |
| Minooka | Lion's Park Bike Path | \$603,825 | \$0 | 13806 |
| Forest Preserve District of Will County | Veterans Memorial Trail from International Dr to Centennial Trail | \$1,447,000 | \$0 | 14205 |
| Wauconda | Garland Rd from Gossell Rd to Old Rand Rd/Main St | \$880,000 | \$0 | 15033 |
| South Elgin | Collins St Bicycle and Pedestrian Bridge from Wills to State St | \$1,791,000 | \$0 | 15775 |
| Elgin | Elgin Bikeway Plan Sherman Hospital-Metra Station Sidepath from Lyle Ave (Big Timber Metra Station) to Randall Rd/Big Timber Rd | \$200,000 | \$0 | 17552 |
| Sugar Grove | Blackberry Creek Shared -Use Path Bridge | \$485,000 | \$0 | 30330 |
| Woodridge | Woodridge Bicycle/Pedestrian Bridge over IL 53 | \$5,427,000 | \$0 | 32993 |
| CDOT | 35th St Bicycle-Pedestrian Bridge | \$17,592,000 | \$0 | 62559 |
| Yorkville | Somonauk St/Game Farm Rd Sidepath from IL 47 to US 34 | \$9,616,800 | \$0 | 203586 |
| Lake County Forest Preserves | Gilmer Road Bike (Multiuse) Path Underpass | \$3,541,000 | \$0 | 912854 |

Doug Ferguson

From: Rogers, Michael D. <Michael.Rogers@Illinois.gov>
Sent: Wednesday, March 27, 2013 2:14 PM
To: Doug Ferguson; Ross Patronsky
Cc: Smith, Herbert; Kroack, Laurel; Demeroukas, Chris; Gebhardt, Chuck; Burkhart, Darwin J.
Subject: Proposed Project Change Amendment to IEPA - Norfolk Southern Railway Diesel Locomotive Retrofit Project (TIP ID 13-10-0005)

Doug and Ross,

The Illinois Environmental Protection Agency (Illinois EPA), as project sponsor of the Norfolk Southern Railway Diesel Locomotive Retrofit Project (TIP ID 13-10-0005), requests the Chicago Metropolitan Agency for Planning's (CMAQ) Congestion Mitigation and Air Quality Improvement Program (CMAQ) Project Selection Committee's consideration of the following proposed amendment to this project. The Illinois EPA would like to amend the existing Norfolk Southern Railway repower project to include the repower of 12 additional Tier 0 diesel-powered switcher locomotives with new engines certified to meet the United States Environmental Protection Agency's (USEPA) Tier 3 line haul emissions standards. The total project cost of this amendment is \$18,960,000 with a 65% federal share of \$12,324,000, increasing the total project cost to \$24,160,000 (\$15,704,000 federal). If approved, we request that the additional funds be programmed into federal fiscal year 2015.

Approval of this amendment would allow the Illinois EPA to request withdrawal of the Illinois EPA-Norfolk Southern Railway Company FY 2014-2018 CMAQ application submitted on February 7, 2013. That application requested \$11,544,000 in CMAQ funds for the repower of 12 switcher locomotives with USEPA certified Tier 2 switcher locomotive engines. The reason that this scope change is being requested is because Norfolk Southern's Juniata Locomotive Shop in Altoona Pennsylvania, where the new engines will be installed, is at capacity through 2014 with orders for CMAQ-funded projects in Atlanta, Pittsburgh, northern New Jersey, and the three mother-slugs in Chicago. Securing the funding commitment in April will ensure the 12 switchers have a spot reserved for the retrofit work in 2015.

Approval of the proposed amendment would also result in the installation of cleaner, Tier 3 certified line haul locomotive engines which would further reduce hydrocarbon, oxides of nitrogen and fine particulate matter emissions beyond the Tier 2 switcher engine emissions levels originally proposed and as described below.

| Pollutant | Existing Locomotives meeting Tier 0 Standards | FY 2014-2018 CMAQ Proposal for Engines Meeting USEPA's Tier 2 Switcher Engine Standards | | Proposed CMAQ Project Scope Change for engines meeting USEPA's Tier 3 Line Haul Engine Standards | | |
|--------------------|---|---|-------------------------------|--|-------------------------------|-------------------------------|
| | Emission Factor * | Emission Factor | Percent Reduction from Tier 0 | Emission Factor | Percent Reduction from Tier 0 | Percent Reduction from Tier 2 |
| Hydrocarbons | 2.10 | 0.6 | 71.4 | 0.30 | 85.7 | 50.0 |
| Oxides of Nitrogen | 11.8 | 8.1 | 31.4 | 5.5 | 53.4 | 32.1 |
| Particulate Matter | 0.26 | 0.13 | 50.0 | 0.10 | 61.5 | 23.1 |

*Emission factors expressed in grams per brake-horsepower hour

Mr. Herbert Smith of Norfolk Southern will be present at the April 11, 2013 CMAQ Project Selection Committee meeting to respond to any questions the Committee members may have.

Please call me with any questions. Thank you for your consideration of this request.

Mike

Mike Rogers

Illinois EPA, Bureau of Air
1021 North Grand Avenue East
Springfield, IL 62794-9276

phone: 217 524-4408

fax: 217 557-2559

e-mail: michael.rogers@illinois.gov

Chicago Metropolitan Agency for Planning

CMAQ Cost Increase Analysis

TIP ID: **13-10-0005**

Description: **Norfolk Southern Railway Co Switchyard Diesel Locomotive Retrofit Project**

Ranking Computation

| | 2010 Award | 2013 Scope Change | 2013 Increase |
|-----------------------|--------------|-------------------|---------------|
| Kilos PM eliminated | 20,865.25 | 15694.3 | 78,380.76 |
| Cost | \$ 5,200,000 | \$ 6,900,000 | \$ 24,160,000 |
| \$/Kilo PM eliminated | \$ 249 | \$ 440 | \$ 308 |
| Rank | 2 | 6 | 3 |

Project Expenses

| | Federal Share | Total | Fed % | Basis |
|-------------------|---------------|---------------|-------|---------------------|
| 2010 Award | \$ 3,380,000 | \$ 5,200,000 | 65.0% | Approved project |
| 2013 Scope Change | \$ 3,380,000 | \$ 6,900,000 | 49.0% | Letter from Sponsor |
| 2013 Cost Change | \$ 15,704,000 | \$ 24,160,000 | 65.0% | Letter from Sponsor |
| Increase Amount | \$ 12,324,000 | \$ 17,260,000 | | |

FY 2010 CMAQ Program

| CMAQ ID | Sponsor | Project | Project Total | Proposed federal | \$ Per Kg VOC |
|-----------------------|--|---|----------------------|-------------------------|----------------------|
| DR01103208 | CTA | Diesel Particulate Filter Retrofit for CTA Buses | \$14,900,000 | \$11,920,000 | \$219 |
| DR13103221 | IEPA | Norfolk Southern Railway Co Switchyard Diesel Locomotive Retrofit Project | \$5,200,000 | \$3,380,000 | \$249 |
| | Cook County Dept of Environmental Control | Cook County DPF Diesel Retrofit | \$2,913,693 | \$582,738 | \$286 |
| Revised Rank 2 | | | | | ↓ \$308 |
| DR01103209 | IEPA | Retrofit of Amtrak Switcher Engines | \$1,500,000 | \$1,200,000 | \$344 |
| DR07103216 | Riverdale | CSXT Barr Rail Yard Switch Engine Retrofit | \$6,000,000 | \$3,900,000 | \$359 |
| DR13103211 | Franklin Park | Indiana Harbor Belt Railroad Switcher Engine Retrofit | \$1,474,000 | \$958,100 | \$396 |
| Revised Rank | | | | | ↓ \$440 |
| DR04103212 | Berkeley | Union Pacific Proviso Railyard Switcher Engine Retrofit | \$12,800,000 | \$5,200,000 | \$441 |
| DR13103215 | Riverdale | Indiana Harbor Belt Railroad Retrofit | \$7,140,000 | \$4,641,000 | \$477 |
| DR06103213 | Bedford Park | BRC Clearing Yard Switcher Retrofit | \$4,305,000 | \$2,798,250 | \$494 |
| DR10103218 | Lake County | Diesel Retrofit Project | \$36,000 | \$23,400 | \$555 |
| DR03103210 | Hoffman Estates | Diesel Fleet Emissions Reduction Project | \$277,000 | \$221,600 | \$673 |
| DR13103220 | Pace | Diesel Engine Retrofits | \$5,850,000 | \$4,680,000 | \$727 |
| DR13103381 | Metra | Installation of GenSets on Two Metra Switch Engines | \$3,500,000 | \$2,800,000 | \$2,269 |
| DR07103214 | Riverdale | Diesel Vehicle Replacement Program | \$275,000 | \$0 | \$5,318 |
| DR08103217 | Itasca | Public Works Diesel Emissions Reduction Project | \$75,000 | \$0 | \$8,612 |
| DR13103222 | IDOT | IDOT Maintenance Fleet Air Pollution Reduction Effort | \$1,870,000 | \$0 | \$12,270 |



"PROGRESS THRU PARTICIPATION"

Department of Public Works

3900 Berdnick Street • Rolling Meadows, Illinois 60008 • 847-963-0500 • Fax: 847-963-0555

March 27, 2013

Ms. Holly Ostdick
Chicago Metropolitan Agency for Planning (CMAP)
233 South Wacker Drive, Suite 800
Chicago, IL 60606

**Subject: Arlington Park Train Station Bicycle Lane Extension (aka
"Commuter Drive")
TIP ID Number 03-08-0004
Revised/Additional Funding Request**

Dear Ms. Ostdick,

The City of Rolling Meadows, as the lead agency, and the Village of Arlington Heights are requesting an additional increase in CMAQ funding for the Arlington Park Train Station Bicycle Lane Extension. This requested funding increase is for \$156,000 as indicated in the following table:

| Project | Limits | TIP No. | Current CMAQ Funding | Revised CMAQ Funding |
|------------------------|---|------------|----------------------|----------------------|
| Bicycle Lane Extension | Rohlwing Rd to Arlington Park Metra Station | 03-08-0004 | \$802,771 | \$958,771 |

Please note that CMAP previously approved an increase in CMAQ funding on 2/14/13 to provide \$255,000 (\$204,000 CMAQ, \$51,000 Local) for the acquisition which is appreciated.

The reason for this revised/additional funding request is due to continuing negotiations and the new position of the Union Pacific Railroad, from the \$5.00 per square foot appraisal value (as commissioned by the local agency, in accordance with IDOT procedures) to a proposed cost of up to \$9.00 per square foot as submitted by Union Pacific Railroad appraisal report received March 7, 2013 (45,651 square foot parcel size total).

At \$5.00 per square foot, the total compensation for the right-of-way and easement acquisition is \$255,000. At \$9.00 per square foot, the total compensation increases to \$450,000. As before, time is of the essence in this project for the completion of the land acquisition process. The project has been placed on the June 14, 2013 IDOT letting schedule, and has experienced multiple recent delays to the complexity and legalities in land negotiations with both Union Pacific Railroad and Arlington Park Racecourse.

We respectfully request that this cost increase be incorporated into the CMAQ Program. We continue to appreciate the CMAP's support and coordination efforts for the project. If you have any questions, please do not hesitate to contact me at (847) 963-0500.

Sincerely,

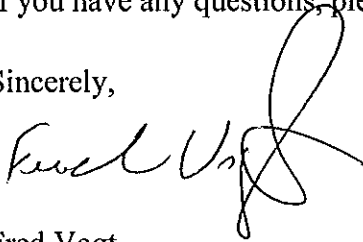
A handwritten signature in black ink, appearing to read "Fred Vogt", with a large, stylized flourish extending upwards and to the right.

Fred Vogt
Director of Public Works

Cc: Matt Lehan, Ciorba Group, Inc.
Mike Walczak, NWMC
Barry Krumstok, City Manager
Jim Massarelli/Tom Ponsot, Village of Arlington Heights

Chicago Metropolitan Agency for Planning

CMAQ Scope Change Analysis

TIP ID: **03-08-0004**

Description: **Arlington Park Train Station Bicycle Lane
Extension**

Ranking Computation

| | 2008 Award | 2011 Cost Increase | 2013 Cost Increase | 2014 Cost Increase |
|-----------------------|------------|-----------------------|-----------------------|-----------------------|
| Tons VOC eliminated | 192.2273 | 192.2273 | 192.2273 | 192.2273 |
| Cost | \$716,000 | \$2,034,252 | \$2,181,786 | \$2,376,786 |
| \$/Ton VOC eliminated | \$3,725 | \$10,583 | \$11,350 | \$12,364 |
| Rank | 9 | 19 | 19 | |

Project Expenses

| | Federal Share | Total | Fed % | Basis |
|--------------------|---------------|-------------|-------|------------------|
| 2008 Award | \$572,000 | \$716,000 | 79.9% | Approved Project |
| 2011 Cost Increase | \$739,000 | \$2,034,252 | 36.3% | Letter from City |
| 2013 Cost Increase | \$802,771 | \$2,181,786 | 36.8% | Letter from City |
| 2013 Cost Increase | \$958,771 | \$2,376,786 | 40.3% | Letter from City |
| Increase Amount | \$156,000 | \$195,000 | | |

\$63,771 \$147,534

Chicago Metropolitan Agency for Planning
FY 2008 CMAQ Proposed Program - CMAQ Project Committee Revised Recommendation

| Council | CMAQ ID | Facility to be Improved | Project Total | Application Federal | \$ Per Kilo VOC Eliminated | Proposed Program |
|-----------------------|-------------------|---|-------------------|---------------------|----------------------------|------------------|
| South | BP07082881 | Homewood-Village of Homewood Bicycle Network - Near and Mid-Term Priorities | \$142,665 | \$114,132 | \$329 | \$114,132 |
| Northwest | BP03082903 | Arlington Heights-Buffalo Creek Bike Path Extension - Intersection of Wilke at Lake Cook Rd | \$60,000 | \$38,000 | \$414 | \$38,000 |
| South | BP07082855 | Hazel Crest-S Kedzie Ave from 167th St to 172nd St | \$195,000 | \$155,000 | \$1,286 | \$22,000 |
| Chicago | BP01082941 | Forest Preserve District of Cook County-North Branch Bicycle Trail Extension | 2013 Cost | \$2,988,000 | \$1,431 | \$359,000 |
| Southwest | BP06082828 | Bedford Park-IL 171/Archer Ave from 65th St to Columbia Dr | \$131,500 | \$96,000 | \$1,753 | |
| Northwest | BP03082860 | Des Plaines-Central Rd from Timothy Ln to East River Rd | \$2,181,786 | \$452,000 | \$2,268 | \$452,000 |
| North Central | BP04082902 | Melrose Park-North Ave Commuter Bicycle Path from Mannheim Rd to Thatcher Ave | \$17 | \$1,223,000 | \$2,782 | \$115,000 |
| Southwest | BP06082926 | Blue Island-Calumet-Sag Trail from Cal-Sag Trail Stage 1 to Burnham Greenway Bike Trail | \$10,568,000 | \$1,120,000 | \$2,844 | \$680,000 |
| Northwest | BP03082946 | Rolling Meadows-Arlington Park Train Station Bicycle Lane Extension | \$716,000 | \$572,000 | \$3,725 | \$152,000 |
| Northwest | BP03082859 | Des Plaines-Des Plaines River Walk from Golf Rd to Algonquin Rd | \$1,310,000 | \$1,048,000 | \$3,923 | \$1,048,000 |
| DuPage | BP08082923 | Carol Stream-Kuhn Rd Bike Path from Lies Rd to The Great Western Trail | \$1,516,000 | \$373,000 | \$4,976 | \$173,000 |
| Kane | BP09082921 | Fox Valley Park District-Fox River Trail Gap Project - Section B | \$1,363,750 | \$600,000 | \$5,289 | \$600,000 |
| Chicago | BP01082949 | CDOT-Bloomington Trail Ridgeway Ave to Kennedy Ewy | \$41,815,000 | \$33,452,000 | \$5,364 | \$1,200,000 |
| Lake | BP10082933 | | 2181786 \$393,283 | \$245,000 | \$6,052 | \$245,000 |
| 2013 Cost Increase | #VALUE! | | 2376786 \$393,283 | \$245,000 | | |
| North Shore | #VALUE! | | 195000 \$735,000 | \$588,000 | \$6,513 | \$28,000 |
| Kane | BP09082875 | Montgomery-Orchard Rd to Fox Valley Bike Trail from Orchard at Aucutt to Aucutt at IL 31 | \$266,000 | \$212,800 | \$7,726 | \$13,200 |
| McHenry | BP11082935 | McHenry County Division of Transportation-McHenry County Prairie Trail | \$949,860 | \$684,800 | \$8,744 | |
| Northwest | #VALUE! | | \$1,423,200 | \$1,138,600 | \$8,949 | |
| McHenry | BP11082945 | Cary-Cary/Algonquin Rd Multi-use Trail from W Main St to N Fox Trails Dr | \$939,400 | \$396,500 | \$9,288 | |
| Revised Rank 1 | | | | | | \$10,583 |
| Revised Rank 2 | | | | | | \$11,350 |
| Revised Rank 3 | | | | | | \$12,364 |
| Lake | | Riverwoods-Deerfield Rd Bike Path | \$1,025,400 | \$820,300 | \$13,438 | |
| Will | | New Lenox-Laraway Rd and Metra SW Station | \$751,500 | \$601,200 | \$15,436 | |
| DuPage | BP08082937 | Woodridge-Woodridge Bicycle/Pedestrian Bridge over IL 53 | \$2,250,000 | \$272,000 | \$15,667 | |
| Will | BP12082942 | Homer Glen-Homer Glen Community Trail - South Extension | \$1,521,000 | \$1,216,800 | \$18,916 | |
| Lake | BP10082877 | Hawthorn Woods-Midlothain Road Bike Path from Kruckenburg/ Heritage Oaks Park to Old McHenry Rd | \$707,000 | \$565,000 | \$19,023 | |
| Kane | BP09082943 | Sugar Grove-Blackberry Creek Pedestrian Bridge from Belle Vue Ln to Gilman Bike Trail | \$420,000 | \$336,000 | \$20,586 | |
| Lake | BP10082909 | Long Grove-Old McHenry Road Multi-Use Path from IL 22 to N of Robert Parker Coffin Rd | \$1,248,000 | \$998,400 | \$21,357 | |
| Will | BP12082938 | New Lenox-Nelson Rd S Bike Path | \$1,295,300 | \$1,036,240 | \$27,689 | |
| Will | BP12082944 | Frankfort-SE Area Community Bike Trail Along Pfeiffer Rd | \$1,702,000 | \$1,233,600 | \$38,179 | |
| Will | BP12082888 | Forest Preserve District of Will County-I-355 Corridor Trail | \$3,055,000 | \$2,444,000 | \$51,037 | |
| Southwest | BP06082857 | Orland Park-Bicycle and Pedestrian bridge Underpass US 45 LaGrange Rd at 156th Pl | \$5,198,000 | \$4,158,400 | \$58,331 | |
| Kane | BP09082904 | Carpentersville-Maple Ave from Washington St to L W Besinger Dr | \$10,590,000 | \$138,300 | \$67,715 | |
| Kane | BP09082887 | Kane County DOT-Anderson Rd from IL 38 to Keslinger Rd | \$2,135,000 | \$1,025,000 | \$112,725 | |
| Kane | BP09082863 | Montgomery-US 30 Bike Trail and Pedestrian Bridge from Simpson Pwy to Southern ROW of US 30 | \$710,000 | \$568,000 | \$340,173 | |

Chicago Metropolitan Agency for Planning

CMAQ Proposals Summarized by Type - FY 2014-2018

| Project Type | Number of Projects | Project Cost | Federal Request |
|-------------------------------|--------------------|-----------------|-----------------|
| Intersection Improvement | 40 | \$572,958,900 | \$274,155,700 |
| Bottleneck Elimination | 6 | \$163,544,000 | \$91,170,000 |
| Transit Service and Equipment | 12 | \$188,899,261 | \$157,475,936 |
| Transit Facility Improvement | 8 | \$313,555,200 | \$247,145,300 |
| Bicycle Facilities | 38 | \$171,108,655 | \$102,085,364 |
| Pedestrian | 9 | \$8,922,790 | \$6,214,400 |
| Bicycle Parking | 4 | \$1,950,362 | \$1,658,090 |
| Bicycle Encouragement | 2 | \$3,405,000 | \$2,724,000 |
| Commuter Parking | 4 | \$23,612,929 | \$13,208,503 |
| Other | 3 | \$3,268,000 | \$2,614,400 |
| Signal Interconnect | 10 | \$22,561,000 | \$13,545,700 |
| Direct Emissions Reduction | 11 | \$240,933,000 | \$124,866,800 |
| | 147 | \$1,714,719,097 | \$1,036,864,193 |